

1. Appointment of Chairman

2. Division of Agenda

To consider whether the discussion of any item of business is likely to lead to the disclosure of exempt information;

3. Declarations of Interest

Members are invited to declare any personal or disclosable pecuniary interests, including the nature and extent of such interests; they may have in any items to be considered at this meeting;

4. Application for New Premises Licence at Bearz Bar, The Kidz & Co, Island Street, Salcombe TQ8 8DP

1 - 80

Members of the public may wish to note that the Council's meeting rooms are accessible by wheelchairs and have a loop induction hearing system

MEMBERS ARE REQUESTED TO SIGN THE ATTENDANCE REGISTER

THIS AGENDA HAS BEEN PRINTED ON ENVIRONMENTALLY FRIENDLY PAPER

If you or someone you know would like this publication in a different format, such as large print or a language other than English, please call Darryl White on 01803 861247 or by email at:
darryl.white@southhams.gov.uk

Agenda Item 4

Report to: **Licensing Sub-Committee**

Date: **19 March 2018**

Title: **Application for a new premises licence at Bearz Bar, The Kidz & Co, Island Street, Salcombe, TQ8 8DP**

Portfolio Area: **Customer First**

Wards Affected: **Salcombe**

Relevant Scrutiny Committee:

Urgent Decision: **Y** Approval and clearance obtained: **Y**

Author: **Naomi Stacey** Role: **Specialist – Licensing**

Contact: **01803 861268 / naomi.stacey@swdevon.gov.uk**

Recommendations:

That the Sub-Committee consider the application for a new Premises Licence and make determinations in respect of this application, namely to:

- i) grant the application as submitted, subject to any Mandatory Conditions required;**
- ii) modify the conditions of the licence;**
- iii) exclude any of the licensable activities to which the application relates;**
- iv) to refuse to specify a person in the licence as the premises supervisor;**
- v) reject the application,**

in line with the licensing objectives contained within the Licensing Act 2003.

1. Executive summary

- 1.1 The purpose of the Licensing Sub-Committee meeting is to determine an application for a new Premises Licence at **Bearz Bar, The Kidz & Co, Island Street, Salcombe, TQ8 8DP** in accordance with Section 18 of the Licensing Act 2003.
- 1.2 The Licensing Authority received an application for a new Premises Licence for the above on 23rd January 2018. The premises is described as a 'lounge bar restaurant serving food and drink.' The premises is over two levels, the main bar and seating area on the ground floor, with a function room and additional seating on the first floor. Also on the first floor of the building and not part of the licensed premises is the 'Kidz & Co' soft play café and crèche. Alcohol purchased in Bearz Bar will not be permitted to be taken off the premises (including into the soft play café). A copy of the application and plan is attached at **Appendix A**.
- 1.3 The application is for:
- Live music: Mon-Thurs from 3pm to 11pm; Fri from 3pm to 11.30pm; Sat from 12pm to 11.30pm; Sun from 10am to 11pm.
 - Recorded music: Mon-Sun from 8am to midnight.
 - Sale of alcohol for consumption on and off the premises: Mon-Sun from 10am to 11.30pm.
 - Opening hours: Mon-Sun from 8am to midnight.
- 1.4 During the consultation period, in liaison with the Police, the applicant has agreed to include additional conditions to address the licensing objectives and reduce the hours for sale of alcohol by 30 minutes to finish at 11pm, with closing time of 11.30pm daily. Details of the changes agreed between the applicant and the Police can be found at **Appendix B**.
- 1.5 In addition to the above, the applicant has confirmed that they are willing to remove their request for the provision of live and recorded music from the premises licence application. However, due to the provisions of the Live Music Act 2012, if a premises licence is granted to allow the sale of alcohol for consumption on the premises, amplified music will automatically be able to be provided between the hours of 10am and 11pm. See further information at 2.7.

2. Background

- 2.1 The premises is located on Island Street in Salcombe, close to the junction with Gould Road. A plan showing the location of the premises and photographs of the area can be found at **Appendix D**.
- 2.2 During the consultation period, fifteen relevant representations were received in objection to the application, including from

Salcombe Town Council and a local District Councillor. Eleven representations were received in support of the application. Copies of the representations are attached at **Appendix C**.

- 2.3 There are concerns raised in relation to all four of the licensing objectives. Issues include noise and disturbance from amplified music and from customers, with particular concern about noise from customers standing outside to smoke. Also mentioned is the safety of customers leaving the premises or standing just outside, due to the fact that there is no pavement on this side of the street and the narrowness of the road itself and the length of time it may take for the Police to attend should there be any anti-social behaviour emanating from the premises.
- 2.4 The fact that part of the building will continue to be used as a soft play café has also been raised as a concern, due to the close proximity of alcohol sales to small children. The applicant has confirmed that the two areas will be run separately and no alcoholic drinks will be permitted in the soft play café area.
- 2.5 Some of the representations have made reference to the 'need' for another licensed premises in the area and the style of the business within the 'Conservation Area.' These are not matters which can be considered under the Licensing Act 2003 which must only take into account issues relating to the four licensing objectives.
- 2.6 Representations received in support of the application list ways in which they believe that the applicant will ensure that the licensing objectives are promoted. These include locating any live music towards the rear of the premises, installing a CCTV system and not allowing drinks to be taken outside of the licensed area.
- 2.7 The Live Music Act 2012 and subsequent amendments, allow the provision of live and recorded amplified music at any premises licensed for the sale of alcohol for consumption on the premises between the hours of 08:00 and 23:00. There is no way to restrict these activities through the premises licence during these hours other than through the review process once a licence has been granted. Music played in the background (at a level where a conversation can be easily held) is never licensable. Should a licence be granted for the sale of alcohol for consumption on the premises from 10am to 11pm as requested, live and recorded amplified music will automatically be permitted during these hours.
- 2.8 As relevant representations in respect of this application have been received, which have not been withdrawn and mediation has not been possible, the Licensing Sub-Committee acting on behalf of the Licensing Authority must make a determination on this application. When coming to a decision, the Licensing Sub-Committee must give consideration to the Council's Statement of Licensing Policy (the Policy) and Home Office guidance issued under Section 182 Licensing Act 2003 (revised April 2017).

- 2.9 Section 3.1 of the Policy states: The Licensing Authority has a duty under the Act to carry out its licensing functions with a view to promoting the four licensing objectives. (These objectives are the only matters to be taken into account in determining the application and any conditions attached must be appropriate to achieve the licensing objectives).
- 2.10 The four licensing objectives are:
- The prevention of crime and disorder
 - Public safety
 - The prevention of public nuisance
 - The protection of children from harm
- 2.11 Section 3.2 of the Policy states: A licence (or club premises certificate) will only be granted where the Licensing Authority is satisfied that these objectives have been met.
- 2.12 Section 4.1 of the Policy sets out additional legislation, strategies, policies and guidance to which the Licensing Authority will have regard.
- 2.13 The Guidance issued under Section 182 of the Licensing Act 2003 which was revised and re-published in April 2017 state: The Licensing Authority may not impose conditions unless its discretion has been engaged following receipt of relevant representations and it is satisfied as a result of a hearing (unless all parties agree a hearing is not necessary) that it is appropriate to impose conditions to promote one or more of the four licensing objectives (paragraph 10.8 of the guidance).
- 2.14 The following responsible authorities are statutory consultees under the Licensing Act 2003:
- Devon and Cornwall Police
 - Devon and Somerset Fire and Rescue Service
 - Devon Safeguarding Children's Board
 - Devon County Council Trading Standards
 - Devon Drug and Alcohol Action Team, NHS Devon
 - South Hams District Council Planning Department
 - South Hams District Council Environmental Health (Health & Safety)
 - South Hams District Council Environmental Health (Pollution Control)
- 2.15 Out of the above responsible authorities, representations were only received from the Police and amendments have been agreed with the applicant.
- 2.16 In addition to the above responsible authorities, any person may make a representation in relation to a premises licence application.

3. Outcomes/outputs

- 3.1 When determining an application for a premises licence, particularly when considering appropriate conditions and operating hours, the following sections of the Statement of Licensing Policy (the policy) and Section 182 Guidance (the guidance) are especially relevant:
- 3.2 Where applications have given rise to representations, any appropriate conditions should normally focus on the most sensitive periods. In certain circumstances, conditions relating to noise immediately surrounding the premises may also prove appropriate to address any disturbance anticipated as customers enter and leave (paragraph 2.19 of the guidance).
- 3.3 Section 6.1 & 6.2 of the policy states: The Licensing Authority will deal with the issue of licensing hours on the individual merits of each application. When the Authority's discretion is engaged, consideration will be given to the individual merits of an application but the presumption will be to grant the hours requested unless there are objections to those hours raised by Responsible Authorities or other persons on the basis of the licensing objectives. However, when dealing with licensing hours beyond midnight it is more likely that relevant representations will be made unless there are higher standards of control within operating schedules to promote the licensing objectives, especially for premises which are situated near residential areas or in areas where anti-social disorder takes place.
- 3.4 Section 6.4 of the policy states: The terminal hours will normally be approved where the Applicant can show that the proposal would not adversely affect the licensing objectives unless, after hearing relevant representation the Licensing Authority believe it necessary, proportionate and reasonable to restrict the hours required. The Licensing Authority may set an earlier terminal hour where it considers this is appropriate to the nature of the activities and the amenity of the area.
- 3.5 Paragraph 10.14 of Guidance issued under Section 182 of the Licensing Act 2003 states: where there are objections to an application to extend the hours during which licensable activities are to be carried on and the licensing authority determines that this would undermine the licensing objectives, it may reject the application or grant it with appropriate conditions and/or different hours from those requested.
- 3.6 Paragraph 10.15 of the Guidance then continues: Shops, stores and supermarkets should normally be free to provide sales of alcohol for consumption off the premises at any times when the retail outlet is open for shopping unless there are good reasons, based on the licensing objectives, for restricting those hours. Section 6.8 of the Policy gives the following as reasons for a restriction: This could be if an individual shop is known to be a focus of disorder and

disturbance and relevant representations have been received. Another such reason may be a particularly early opening time, where there are reasons to believe that the availability of alcohol at that hour could impact adversely on the licensing objectives.

- 3.7 Section 10.1 of the Policy states: The Licensing Authority recognises the great variety of premises for which licences may be sought. These will include theatres, cinemas, restaurants, pubs, nightclubs, cafes, takeaways, community halls and schools. Access by children to all types of premises will not be limited unless it is considered necessary to do so in order to protect them from harm.
- 3.8 Section 10.2 of the Policy states: When deciding whether or not to limit access to children the Licensing Authority will judge each application on its own individual merits. Examples which may give rise to concern and warrant restrictions in the operating schedule include premises: -
- ❑ where entertainment of an adult or sexual nature is provided
 - ❑ where there is a strong element of gambling taking place
 - ❑ with a known association with drug taking or dealing
 - ❑ where there have been convictions of the current management for serving alcohol to minors
 - ❑ with a reputation for allowing underage drinking
 - ❑ where the supply of alcohol for consumption on the premises is exclusive or primary purpose of the services provided at the premises.
- 3.9 The desired outcome is a determination of the application with reasons provided which relate to the four licensing objectives and when conditions are imposed, that these are appropriate to address the licensing objectives.

4. Options available and consideration of risk

- 4.1 The Licensing Authority may decide to impose additional conditions to address the four licensing objectives, or to amend or remove requested licensable activities. When coming to their decision the Licensing Sub-Committee must give consideration to the Section 182 Guidance and the Statement of Licensing Policy. Reasons must be given which relate to the licensing objectives for any decision made.
- 4.2 The Sub-Committee will need to consider the hours of operation proposed, the effectiveness of the operating schedule proposed by the applicant, the representations received, the location of the premises in relation to residential properties, the history of the management of the premises (if applicable), the evidence provided of any problems in the past, the likely impact of any extension of hours and activities, public transport, taxi availability, the right the applicant has to operate a business and balancing the rights of residents to the quiet enjoyment and privacy of family life. The South Hams relies on tourism, with the population in the district

doubling in the summer months with holidaymakers both from this country and international visitors who are, in the main, families with young children and retired people – the very segment of society who would perhaps be deterred by anti-social behaviour. These, and any other relevant issues, may be explored at the hearing in so far as it reflects the four licensing objectives.

- 4.3 A decision made by the Licensing Sub-Committee may be appealed by the applicant or any person who has made relevant representations. The right of appeal is to the Magistrates’ Court by virtue of Section 181 and Schedule 5 of the Licensing Act 2003. The Magistrates’ Court may dismiss the appeal, or substitute its own decision, or send back the case to the Licensing Authority with directions as to how the case is to be dealt with. The Magistrates’ Court may make any costs order it thinks fit.
- 4.4 The Licensing Act 2003 contains a provision which enables a responsible authority or any other person to apply to this Licensing Authority for a review of the premises licence once granted. A hearing follows which enables the Sub-Committee to use the normal powers available, but also to suspend the licence for a period of up to three months or to withdraw it.

5. Proposed Way Forward

- 5.1 That the Sub-Committee consider the application for a new Premises Licence and make a determination in respect of this application, namely to:
 - i) grant the application as submitted, subject to any Mandatory Conditions required;
 - ii) modify the conditions of the licence;
 - iii) exclude any of the licensable activities to which the application relates;
 - iv) to refuse to specify a person in the licence as the premises supervisor;
 - v) reject the application,

in line with the licensing objectives (Section 4) contained within the Licensing Act 2003.

6. Implications

Implications	Relevant to proposals Y/N	Details and proposed measures to address

Legal/Governance	Y	<p>The Licensing Act 2003 gives Licensing Authorities the responsibility for determining applications submitted under this provision. This is a statutory obligation.</p> <p>As there have been relevant representations in respect of this application which have not been resolved, this hearing must be held. Relevant representations are about the likely effect of the grant of the application on the promotion of the licensing objectives, by responsible authorities or any other person. The Licensing Sub-Committee must disregard any information or evidence not relevant to the licensing objectives.</p> <p>The Licensing Sub-Committee must consider this application in accordance with Section 4 of the Licensing Act 2003, which requires that licensing functions must be carried out with a view to promoting the four licensing objectives. The Licensing Authority must also have regard to its own licensing policy and the Secretary of State's guidance, but may depart from both if it has good reason to do so. Those reasons should be stated.</p> <p>The Act requires (Section 18) that in dealing with a new premises licence application, the committee takes any of the following steps which are appropriate for the promotion of the licensing objectives:</p> <ul style="list-style-type: none"> (a) to grant the licence subject to:- <ul style="list-style-type: none"> i) the conditions mentioned in section 18 (2)(a) [ie as applied for] modified to such an extent as the authority considers necessary for the promotion of the licensing objectives, and ii) any conditions which must under section 19, 20 or 21 be included in the licence; (b) to exclude from the scope of the licence any of the licensable activities to which the application relates; (c) to reject the application <p>The Sub-Committee must give its reasons for its decision to take any of these steps. Similarly, if the application is rejected, the Sub-Committee must give its reasons.</p> <p>The applicant or any person who has made relevant representations has the right to appeal a decision made by the Licensing Sub-Committee to the Magistrates' Court by virtue of Section 181 and Schedule 5 of Licensing Act 2003.</p>
------------------	---	--

		<p>On appeal, the Magistrates' Court may:</p> <ul style="list-style-type: none"> a) dismiss the appeal; b) substitute for the decision appeal against another decision which could have been made by the Licensing authority; c) remit the case to the Licensing Authority to dispose of it in accordance with the direction of the court.
Financial	N	There are no direct financial implications to the Council from this Report. However, should a decision be challenged this could result in the Council facing an appeal to the Magistrates Court with the risk of costs being awarded against the Council.
Risk	Y	<p>The Licensing Authority must follow strict legislation in accordance with the Licensing Act 2003 and adhere to the statutory instruments contained with the Act.</p> <p>All decisions must be taken in consideration of the four licensing objectives (section 2.3). These objectives are in place to give protection to the public from the potential negative impacts caused by licensed premises.</p> <p>Decisions may be appealed (see financial and legal/governance sections above).</p>
Comprehensive Impact Assessment Implications		
Equality and Diversity		Compliance with the Human Rights Act 1998 – Article 6: right to a fair trial.
Safeguarding		All decisions must take into consideration the 'protection of children from harm' licensing objective.
Community Safety, Crime and Disorder		Section 17 Crime and Disorder Act 1998 applies. Decisions made must relate to the four licensing objectives as detailed in section 2.3 of this report.
Health, Safety and Wellbeing		All decisions must take into consideration the four licensing objectives, including 'public safety' and 'protection of children from harm'.
Other implications		

Supporting Information

Appendices:

Appendix A – premises licence application and plan

Appendix B – amendments agreed between the Police and the Applicant

Appendix C – representations

Appendix D – location map and photographs

Background Papers:

[under provisions of the Local Government Act 1972]

The Licensing Act 2003

Guidance issued under Section 182 of the Licensing Act 2003

South Hams District Council's Statement of Licensing Policy

Responses to Notices of Hearing

Agreement from Applicant to Police amendments

Consent to be DPS form

* required information

Section 1 of 21

You can save the form at any time and resume it later. You do not need to be logged in when you resume.

System reference

Not Currently In Use

This is the unique reference for this application generated by the system.

Your reference

Bearz Bar - The Kidz & Co

You can put what you want here to help you track applications if you make lots of them. It is passed to the authority.

Are you an agent acting on behalf of the applicant?

Yes No

Put "no" if you are applying on your own behalf or on behalf of a business you own or work for.

Applicant Details

* First name

Corinne

* Family name

Lynn

* E-mail

[Redacted]

Main telephone number

[Redacted]

Include country code.

Other telephone number

[Redacted]

Indicate here if you would prefer not to be contacted by telephone

Are you:

Applying as a business or organisation, including as a sole trader
 Applying as an individual

A sole trader is a business owned by one person without any special legal structure. Applying as an individual means you are applying so you can be employed, or for some other personal reason, such as following a hobby.

Applicant Business

Is your business registered in the UK with Companies House?

Yes No

Note: completing the Applicant Business section is optional in this form.

Is your business registered outside the UK?

Yes No

Business name

The Kidz & Co

If your business is registered, use its registered name.

VAT number

- [Redacted]

Put "none" if you are not registered for VAT.

Legal status

Sole Trader

Continued from previous page...

Your position in the business

Home country

The country where the headquarters of your business is located.

Business Address

If you have one, this should be your official address - that is an address required of you by law for receiving communications.

Building number or name

Street

District

City or town

County or administrative area

Postcode

Country

Section 2 of 21

PREMISES DETAILS

I/we, as named in section 1, apply for a premises licence under section 17 of the Licensing Act 2003 for the premises described in section 2 below (the premises) and I/we are making this application to you as the relevant licensing authority in accordance with section 12 of the Licensing Act 2003.

Premises Address

Are you able to provide a postal address, OS map reference or description of the premises?

Address OS map reference Description

Postal Address Of Premises

Building number or name

Street

District

City or town

County or administrative area

Postcode

Country

Further Details

Telephone number

Non-domestic rateable value of premises (£)

Section 3 of 21

APPLICATION DETAILS

In what capacity are you applying for the premises licence?

- An individual or individuals
- A limited company / limited liability partnership
- A partnership (other than limited liability)
- An unincorporated association
- Other (for example a statutory corporation)
- A recognised club
- A charity
- The proprietor of an educational establishment
- A health service body
- A person who is registered under part 2 of the Care Standards Act 2000 (c14) in respect of an independent hospital in Wales
- A person who is registered under Chapter 2 of Part 1 of the Health and Social Care Act 2008 in respect of the carrying on of a regulated activity (within the meaning of that Part) in an independent hospital in England
- The chief officer of police of a police force in England and Wales

Confirm The Following

- I am carrying on or proposing to carry on a business which involves the use of the premises for licensable activities
- I am making the application pursuant to a statutory function
- I am making the application pursuant to a function discharged by virtue of Her Majesty's prerogative

Section 4 of 21

INDIVIDUAL APPLICANT DETAILS

Applicant Name

Is the name the same as (or similar to) the details given in section one?

- Yes No

If "Yes" is selected you can re-use the details from section one, or amend them as required. Select "No" to enter a completely new set of details.

First name

Family name

Is the applicant 18 years of age or older?

- Yes No

Continued from previous page...

Current Residential Address

Is the address the same as (or similar to) the address given in section one?

Yes No

If "Yes" is selected you can re-use the details from section one, or amend them as required. Select "No" to enter a completely new set of details.

Building number or name

Street

District

City or town

County or administrative area

Postcode

Country

Applicant Contact Details

Are the contact details the same as (or similar to) those given in section one?

Yes No

If "Yes" is selected you can re-use the details from section one, or amend them as required. Select "No" to enter a completely new set of details.

E-mail

Telephone number

Other telephone number

* Date of birth / /
dd mm yyyy

* Nationality Documents that demonstrate entitlement to work in the UK

Add another applicant

Section 5 of 21

OPERATING SCHEDULE

When do you want the premises licence to start? / /
dd mm yyyy

If you wish the licence to be valid only for a limited period, when do you want it to end / /
dd mm yyyy

Provide a general description of the premises

For example the type of premises, its general situation and layout and any other information which could be relevant to the licensing objectives. Where your application includes off-supplies of alcohol and you intend to provide a place for consumption of these off- supplies you must include a description of where the place will be and its proximity to the premises.

SPACIOUS WATERSIDE VIEW LOUNGE BAR RESTAURANT SERVING FOOD AND DRINK. GROUND FLOOR CONSISTING OF THE

Continued from previous page...

BAR AREA, SEATING AREAS, THREE W.C.'S (INCLUDING 1XDISABLED), A DELI-STYLE FOOD COUNTER AND AT THE REAR OF THE BUILDING A SLIGHTLY ELEVATED 'STAGE' AREA FOR LIVE MUSIC. ON THE IMMEDIATE FIRST FLOOR IS ADDITIONAL SEATING AREA AND FUNCTION ROOM SERVING FOOD AND DRINK- WHERE NEW KITCHEN IS TO BE INSTALLED IN 2019. ENTRANCE TO CURRENT 'KIDZ & CO' SOFT PLAY CAFE AND CRECHE ON FIRST FLOOR, SERVING NON-ALCOHOLIC BEVERAGES AND FOOD DURING SEPARATE OPENING HOURS TO THE LOUNGE BAR AND FUNCTION ROOM. THIS SOFT PLAY CAFE AREA INCLUDES A PLAY AREA, SEATING AREA, KITCHEN AND TWO W.C.'S. AFTER LICENSE IS IN PLACE THE LOUNGE BAR AND FUNCTION ROOM SHALL BE RENAMED TO 'BEARZ BAR' TO SEPARATE IT FROM 'THE KIDZ & CO'

If 5,000 or more people are expected to attend the premises at any one time, state the number expected to attend

Section 6 of 21

PROVISION OF PLAYS

See guidance on regulated entertainment

Will you be providing plays?

- Yes No

Section 7 of 21

PROVISION OF FILMS

See guidance on regulated entertainment

Will you be providing films?

- Yes No

Section 8 of 21

PROVISION OF INDOOR SPORTING EVENTS

See guidance on regulated entertainment

Will you be providing indoor sporting events?

- Yes No

Section 9 of 21

PROVISION OF BOXING OR WRESTLING ENTERTAINMENTS

See guidance on regulated entertainment

Will you be providing boxing or wrestling entertainments?

- Yes No

Section 10 of 21

PROVISION OF LIVE MUSIC

See guidance on regulated entertainment

Will you be providing live music?

- Yes No

Standard Days And Timings

MONDAY

Start

Start

End

End

Give timings in 24 hour clock. (e.g., 16:00) and only give details for the days of the week when you intend the premises to be used for the activity.

Continued from previous page...

TUESDAY

Start End

Start End

WEDNESDAY

Start End

Start End

THURSDAY

Start End

Start End

FRIDAY

Start End

Start End

SATURDAY

Start End

Start End

SUNDAY

Start End

Start End

Will the performance of live music take place indoors or outdoors or both?

Indoors Outdoors Both

Where taking place in a building or other structure tick as appropriate. Indoors may include a tent.

State type of activity to be authorised, if not already stated, and give relevant further details, for example (but not exclusively) whether or not music will be amplified or unamplified.

LIVE MUSIC TO BE EITHER AMPLIFIED OR UNAMPLIFIED. SOME MELLOW JAZZ ON A SUNDAY DURING SERVICE OF SUNDAY ROASTS FOR EXAMPLE WOULD BE AMPLIFIED BUT NOT INTRUSIVE. SOME AFTERNOONS (NOT ALL), SOME NICE ACOUSTIC GUITAR AND VOCALS DURING AFTERNOON CREAM TEAS. THEN THE OPTION TO HAVE LIVE BANDS IN THE EVENINGS WOULD BE GOOD FOR EVENTS, BIRTHDAYS, AND SEASONAL.

State any seasonal variations for the performance of live music

For example (but not exclusively) where the activity will occur on additional days during the summer months.

DURING SCHOOL HOLIDAYS THE LIVE MUSIC WOULD BE MORE FREQUENT. I HAVE TYPED IN MAXIMUM TIMES REQUIRED AS 'STANDARD DAYS AND TIMINGS' ABOVE AS WE WOULD NOT REQUIRE MORE THAN THOSE TIMES ON THOSE DAYS IN THE HEIGHT OF THE SEASON. ON AVERAGE WE WOULD DO 2/3 LIVE MUSIC SLOTS A WEEK.

Non-standard timings. Where the premises will be used for the performance of live music at different times from those listed in the column on the left, list below

Continued from previous page...

For example (but not exclusively), where you wish the activity to go on longer on a particular day e.g. Christmas Eve.

CURRENTLY NO NON-STANDARD TIMINGS

Section 11 of 21

PROVISION OF RECORDED MUSIC

See guidance on regulated entertainment

Will you be providing recorded music?

Yes No

Standard Days And Timings

MONDAY

Start

End

Start

End

Give timings in 24 hour clock.
(e.g., 16:00) and only give details for the days
of the week when you intend the premises
to be used for the activity.

TUESDAY

Start

End

Start

End

WEDNESDAY

Start

End

Start

End

THURSDAY

Start

End

Start

End

FRIDAY

Start

End

Start

End

SATURDAY

Start

End

Start

End

SUNDAY

Start

End

Start

End

Will the playing of recorded music take place indoors or outdoors or both?

Indoors Outdoors Both

Where taking place in a building or other structure tick as appropriate. Indoors may include a tent.

Continued from previous page...

State type of activity to be authorised, if not already stated, and give relevant further details, for example (but not exclusively) whether or not music will be amplified or unamplified.

NON- INTRUSIVE BACKGROUND MUSIC THROUGHOUT ALL AREAS DURING OPENING HOURS. IN THE EVENINGS DURING BUSY PERIODS, MUSIC WILL BE TURNED UP IN REAR SECTION BUT FRONT DOORS WILL BE CLOSED TO KEEP THE NOISE DOWN FOR THE NEIGHBOURS

State any seasonal variations for playing recorded music

For example (but not exclusively) where the activity will occur on additional days during the summer months.

IN THE EVENINGS DURING BUSY PERIODS, MUSIC WILL BE TURNED UP IN REAR SECTION BUT FRONT DOORS WILL BE CLOSED TO REDUCE NOISE.

Non-standard timings. Where the premises will be used for the playing of recorded music at different times from those listed in the column on the left, list below

For example (but not exclusively), where you wish the activity to go on longer on a particular day e.g. Christmas Eve.

Section 12 of 21

PROVISION OF PERFORMANCES OF DANCE

See guidance on regulated entertainment

Will you be providing performances of dance?

Yes No

Section 13 of 21

PROVISION OF ANYTHING OF A SIMILAR DESCRIPTION TO LIVE MUSIC, RECORDED MUSIC OR PERFORMANCES OF DANCE

See guidance on regulated entertainment

Will you be providing anything similar to live music, recorded music or performances of dance?

Yes No

Section 14 of 21

LATE NIGHT REFRESHMENT

Will you be providing late night refreshment?

Yes No

Section 15 of 21

SUPPLY OF ALCOHOL

Will you be selling or supplying alcohol?

Yes No

Standard Days And Timings

Continued from previous page...

MONDAY

Start

End

Start

End

Give timings in 24 hour clock.
(e.g., 16:00) and only give details for the days
of the week when you intend the premises
to be used for the activity.

TUESDAY

Start

End

Start

End

WEDNESDAY

Start

End

Start

End

THURSDAY

Start

End

Start

End

FRIDAY

Start

End

Start

End

SATURDAY

Start

End

Start

End

SUNDAY

Start

End

Start

End

Will the sale of alcohol be for consumption:

- On the premises Off the premises Both

If the sale of alcohol is for consumption on
the premises select on, if the sale of alcohol
is for consumption away from the premises
select off. If the sale of alcohol is for
consumption on the premises and away
from the premises select both.

State any seasonal variations

For example (but not exclusively) where the activity will occur on additional days during the summer months.

DURING QUIETER PERIODS WE SHALL NOT BE OPEN AS LATE.

Non-standard timings. Where the premises will be used for the supply of alcohol at different times from those listed in the column on the left, list below

Continued from previous page...

For example (but not exclusively), where you wish the activity to go on longer on a particular day e.g. Christmas Eve.

State the name and details of the individual whom you wish to specify on the licence as premises supervisor

Name

First name

Family name

Date of birth / /

Enter the contact's address

Building number or name

Street

District

City or town

County or administrative area

Postcode

Country

Personal Licence number (if known)

Issuing licensing authority (if known)

PROPOSED DESIGNATED PREMISES SUPERVISOR CONSENT

How will the consent form of the proposed designated premises supervisor be supplied to the authority?

- Electronically, by the proposed designated premises supervisor
- As an attachment to this application

Reference number for consent form (if known)

If the consent form is already submitted, ask the proposed designated premises supervisor for its 'system reference' or 'your reference'.

Section 16 of 21

ADULT ENTERTAINMENT

Continued from previous page...

Highlight any adult entertainment or services, activities, or other entertainment or matters ancillary to the use of the premises that may give rise to concern in respect of children

Give information about anything intended to occur at the premises or ancillary to the use of the premises which may give rise to concern in respect of children, regardless of whether you intend children to have access to the premises, for example (but not exclusively) nudity or semi-nudity, films for restricted age groups etc gambling machines etc.

Section 17 of 21

HOURS PREMISES ARE OPEN TO THE PUBLIC

Standard Days And Timings

MONDAY

Start 08:00

End

Start

End 24:00

Give timings in 24 hour clock. (e.g., 16:00) and only give details for the days of the week when you intend the premises to be used for the activity.

TUESDAY

Start 08:00

End

Start

End 24:00

WEDNESDAY

Start 08:00

End

Start

End 24:00

THURSDAY

Start 08:00

End

Start

End 24:00

FRIDAY

Start 08:00

End

Start

End 24:00

SATURDAY

Start 08:00

End

Start

End 24:00

SUNDAY

Start 08:00

End

Start

End 24:00

State any seasonal variations

For example (but not exclusively) where the activity will occur on additional days during the summer months.

Continued from previous page...

FEWER OPENING HOURS OUT OF SEASON

Non standard timings. Where you intend to use the premises to be open to the members and guests at different times from those listed in the column on the left, list below

For example (but not exclusively), where you wish the activity to go on longer on a particular day e.g. Christmas Eve.

Section 18 of 21

LICENSING OBJECTIVES

Describe the steps you intend to take to promote the four licensing objectives:

a) General – all four licensing objectives (b,c,d,e)

List here steps you will take to promote all four licensing objectives together.

SUFFICIENT TABLES AND CHAIRS WILL BE AVAILABLE WITHIN THE PREMISES TO ACCOMMODATE ALL CUSTOMERS. THE TOTAL OCCUPANCY AT ANY ONE TIME WILL BE IN AGREEMENT WITH THE LICENSING AUTHORITY AS WELL AS DEVON & CORNWALL POLICE IN RELATION TO OUR FIRE RISK ASSESSMENT, AS WELL AS THE NUMBER OF TOILETS AVAILABLE AND THE FLOOR SPACE.
WE SHALL USE A PHYSICAL HEAD COUNT AS WELL AS OUR TABLE BOOKINGS AS METHOD TO CHECK NUMBER OF PEOPLE ON THE PREMISES.

b) The prevention of crime and disorder

ALL BOTTLES AND GLASSES WILL BE REMOVED FROM PUBLIC AREAS AS SOON AS THEY ARE FINISHED WITH OR EMPTY. ALCOHOL SOLD FOR CONSUMPTION OFF THE PREMISES WILL BE SOLD IN SEALED CONTAINERS ONLY.
CCTV WILL BE INSTALLED AND OPERATIVE AT ALL TIMES IN THE LOUNGE BAR AND FUNCTION ROOM DURING OPENING HOURS. OUR EQUIPMENT MUST BE MAINTAINED TO THE SATISFACTION OF THE CHIEF OF POLICE AS WELL AS BEING RETAINED FOR 31 DAYS AND MADE AVAILABLE TO POLICE OFFICERS ON REQUEST, AT ANY REASONABLE TIME.
IF THE CCTV EQUIPMENT IS INOPERATIVE, THE POLICE AND LICENSING AUTHORITY WILL BE NOTIFIED AS SOON AS POSSIBLE AND IMMEDIATE STEPS WILL BE TAKEN TO GET ALL EQUIPMENT BACK IN FULL WORKING ORDER.
A NOTICE WILL BE DISPLAYED AT THE ENTRANCE TO THE PREMISES ADVISING THAT CCTV IS IN OPERATION.
AN INCIDENT BOOK WILL BE KEPT TO RECORD THE DETAILS OF ALL INSTANCES OF REFUSED SALES TOGETHER WITH THE DESCRIPTION OF THE CUSTOMER AND REASON FOR REFUSAL. THE INCIDENT BOOK WILL BE AVAILABLE TO THE POLICE & WEIGHTS AND MEASURES.

c) Public safety

THERE WILL BE ADEQUATE ARRANGEMENTS FOR FIRST AID PROVISION. A FIRST AID BOX SHALL BE KEPT, ADEQUATELY STOCKED IN THE LOUNGE BAR AREA, THE FUNCTION ROOM, THE SOFT PLAY CAFE AND ALSO THE OFFICE. STAFF WILL BE ADEQUATELY TRAINED AND PROCEDURES WILL BE IN PLACE TO ENSURE BODY FLUIDS ARE DEALT WITH IN A SAFE MANNER TO AVOID ANY RISK OF COMMUNICABLE DISEASE.
ALL THE BUILDINGS ELECTRICS AND PORTABLE APPLIANCES WILL BE INSPECTED BY A COMPETENT PERSON ANNUALLY, TO ENSURE SAFETY.
ALL GAS HAS BEEN REMOVED FROM THE PREMISES.
WHEN DISABLED PEOPLE ARE PRESENT, ADEQUATE ARRANGEMENTS WILL EXIST TO ENABLE THEIR SAFE EVACUATION IN THE EVENT OF AN EMERGENCY.

Continued from previous page...

ALL GANGWAYS, EXIT ROUTES AND STEPS ARE CLEARLY MARKED, MAINTAINED IN GOOD ORDER, WELL LIT AND THE SURFACES KEPT NON-SLIPPERY

d) The prevention of public nuisance

ALL RUBBISH STORED OUTSIDE AND PRODUCED BY THE PREMISES AWAITING COLLECTION WILL BE KEPT IN THE SECURED DESIGNATED AREA, TO PREVENT LITTER BEING BLOWN AROUND.
THE DELIVERY OF GOODS WILL BE RESTRICTED TO BETWEEN 07:00 AND 19:00.
LIVE MUSIC SHALL BE PLAYED AT THE REAR OF THE BUILDING, TO PREVENT DISTURBANCE TO ANY NEIGHBOURS.
NOISE OR VIBRATION WILL NOT EMANATE FROM THE PREMISES SUCH AS TO CAUSE PERSONS IN THE NEIGHBOURHOOD TO BE UNREASONABLY DISTURBED.
SUITABLE SIGNAGE WILL BE PROVIDED AT THE EXIT REQUESTING PATRONS TO MAKE AS LITTLE NOISE AS POSSIBLE WHEN LEAVING THE PREMISES AND VICINITY AS QUIETLY AND QUICKLY AS POSSIBLE.
VENTILATION EQUIPMENT WILL BE REGULARLY CLEANED AND MAINTAINED TO MINIMISE THE LEVELS OF ODOUR GENERATED BY THE PREMISES.

e) The protection of children from harm

There will be a "Challenge 25" proof of age policy. Any person who appears to be under the age of 25 years will have to provide valid identification before they are allowed to purchase alcohol or consume alcohol on the premises. The only forms of identification accepted will be a valid photo driving license or passport.
There will be no gaming machines installed.

Section 19 of 21

NOTES ON DEMONSTRATING ENTITLEMENT TO WORK IN THE UK

Continued from previous page...

Entitlement to work/immigration status for individual applicants and applications from partnerships which are not limited liability partnerships:

A licence may not be held by an individual or an individual in a partnership who is resident in the UK who:

- does not have the right to live and work in the UK; or
- is subject to a condition preventing him or her from doing work relating to the carrying on of a licensable activity.

Any premises licence issued in respect of an application made on or after 6 April 2017 will become invalid if the holder ceases to be entitled to work in the UK.

Applicants must demonstrate that they have an entitlement to work in the UK and are not subject to a condition preventing them from doing work relating to the carrying on of a licensable activity. They do this by providing with this application copies or scanned copies of the following documents (which do not need to be certified).

Documents which demonstrate entitlement to work in the UK

- An expired or current passport showing the holder, or a person named in the passport as the child of the holder, is a British citizen or a citizen of the UK and Colonies having the right of abode in the UK [please see note below about which sections of the passport to copy].
- An expired or current passport or national identity card showing the holder, or a person named in the passport as the child of the holder, is a national of a European Economic Area country or Switzerland.
- A Registration Certificate or document certifying permanent residence issued by the Home Office to a national of a European Economic Area country or Switzerland.
- A Permanent Residence Card issued by the Home Office to the family member of a national of a European Economic Area country or Switzerland.
- A **current** Biometric Immigration Document (Biometric Residence Permit) issued by the Home Office to the holder indicating that the person named is allowed to stay indefinitely in the UK, or has no time limit on their stay in the UK.
- A **current** passport endorsed to show that the holder is exempt from immigration control, is allowed to stay indefinitely in the UK, has the right of abode in the UK, or has no time limit on their stay in the UK.
- A **current** Immigration Status Document issued by the Home Office to the holder with an endorsement indicating that the named person is allowed to stay indefinitely in the UK or has no time limit on their stay in the UK, **when produced in combination with** an official document giving the person's permanent National Insurance number and their name issued by a Government agency or a previous employer.
- A **full** birth or adoption certificate issued in the UK which includes the name(s) of at least one of the holder's parents or adoptive parents, **when produced in combination with** an official document giving the person's permanent National Insurance number and their name issued by a Government agency or a previous employer.
- A birth or adoption certificate issued in the Channel Islands, the Isle of Man or Ireland **when produced in combination with** an official document giving the person's permanent National Insurance number and their name issued by a Government agency or a previous employer.
- A certificate of registration or naturalisation as a British citizen, **when produced in combination with** an official document giving the person's permanent National Insurance number and their name issued by a Government agency or a previous employer.
- A **current** passport endorsed to show that the holder is allowed to stay in the UK and is currently allowed to work and is not subject to a condition preventing the holder from doing work relating to the carrying on of a licensable activity.

Continued from previous page...

- A **current** Biometric Immigration Document (Biometric Residence Permit) issued by the Home Office to the holder which indicates that the named person can currently stay in the UK and is allowed to work relation to the carrying on of a licensable activity.
- A **current** Residence Card issued by the Home Office to a person who is not a national of a European Economic Area state or Switzerland but who is a family member of such a national or who has derivative rights or residence.
- A **current** Immigration Status Document containing a photograph issued by the Home Office to the holder with an endorsement indicating that the named person may stay in the UK, and is allowed to work and is not subject to a condition preventing the holder from doing work relating to the carrying on of a licensable activity **when produced in combination with** an official document giving the person's permanent National Insurance number and their name issued by a Government agency or a previous employer.
- A Certificate of Application, **less than 6 months old**, issued by the Home Office under regulation 17(3) or 18A (2) of the Immigration (European Economic Area) Regulations 2006, to a person who is not a national of a European Economic Area state or Switzerland but who is a family member of such a national or who has derivative rights of residence.
- Reasonable evidence that the person has an outstanding application to vary their permission to be in the UK with the Home Office such as the Home Office acknowledgement letter or proof of postage evidence, or reasonable evidence that the person has an appeal or administrative review pending on an immigration decision, such as an appeal or administrative review reference number.
- Reasonable evidence that a person who is not a national of a European Economic Area state or Switzerland but who is a family member of such a national or who has derivative rights of residence in exercising treaty rights in the UK including:-
 - evidence of the applicant's own identity – such as a passport,
 - evidence of their relationship with the European Economic Area family member – e.g. a marriage certificate, civil partnership certificate or birth certificate, and
 - evidence that the European Economic Area national has a right of permanent residence in the UK or is one of the following if they have been in the UK for more than 3 months:
 - (i) working e.g. employment contract, wage slips, letter from the employer,
 - (ii) self-employed e.g. contracts, invoices, or audited accounts with a bank,
 - (iii) studying e.g. letter from the school, college or university and evidence of sufficient funds; or
 - (iv) self-sufficient e.g. bank statements.

Family members of European Economic Area nationals who are studying or financially independent must also provide evidence that the European Economic Area national and any family members hold comprehensive sickness insurance in the UK. This can include a private medical insurance policy, an EHIC card or an S1, S2 or S3 form.

Original documents must not be sent to licensing authorities. If the document copied is a passport, a copy of the following pages should be provided:-

- (i) any page containing the holder's personal details including nationality;
- (ii) any page containing the holder's photograph;
- (iii) any page containing the holder's signature;
- (iv) any page containing the date of expiry; and
- (v) any page containing information indicating the holder has permission to enter or remain in the UK and is permitted to work.

If the document is not a passport, a copy of the whole document should be provided.

Your right to work will be checked as part of your licensing application and this could involve us checking your immigration status with the Home Office. We may otherwise share information with the Home Office. Your licence application will not be determined until you have complied with this guidance.

Section 20 of 21

NOTES ON REGULATED ENTERTAINMENT

Continued from previous page...

In terms of specific **regulated entertainments** please note that:

- Plays: no licence is required for performances between 08:00 and 23.00 on any day, provided that the audience does not exceed 500.
- Films: no licence is required for 'not-for-profit' film exhibition held in community premises between 08.00 and 23.00 on any day provided that the audience does not exceed 500 and the organiser (a) gets consent to the screening from a person who is responsible for the premises; and (b) ensures that each such screening abides by age classification ratings.
- Indoor sporting events: no licence is required for performances between 08.00 and 23.00 on any day, provided that the audience does not exceed 1000.
- Boxing or Wrestling Entertainment: no licence is required for a contest, exhibition or display of Greco-Roman wrestling, or freestyle wrestling between 08.00 and 23.00 on any day, provided that the audience does not exceed 1000. Combined fighting sports – defined as a contest, exhibition or display which combines boxing or wrestling with one or more martial arts – are licensable as a boxing or wrestling entertainment rather than an indoor sporting event.
- Live music: no licence permission is required for:
 - o a performance of unamplified live music between 08.00 and 23.00 on any day, on any premises.
 - o a performance of amplified live music between 08.00 and 23.00 on any day on premises authorised to sell alcohol for consumption on those premises, provided that the audience does not exceed 500.
 - o a performance of amplified live music between 08.00 and 23.00 on any day, in a workplace that is not licensed to sell alcohol on those premises, provided that the audience does not exceed 500.
 - o a performance of amplified live music between 08.00 and 23.00 on any day, in a church hall, village hall, community hall, or other similar community premises, that is not licensed by a premises licence to sell alcohol, provided that (a) the audience does not exceed 500, and (b) the organiser gets consent for the performance from a person who is responsible for the premises.
 - o a performance of amplified live music between 08.00 and 23.00 on any day, at the non-residential premises of (i) a local authority, or (ii) a school, or (iii) a hospital, provided that (a) the audience does not exceed 500, and (b) the organiser gets consent for the performance on the relevant premises from: (i) the local authority concerned, or (ii) the school or (iii) the health care provider for the hospital.
- Recorded Music: no licence permission is required for:
 - o any playing of recorded music between 08.00 and 23.00 on any day on premises authorised to sell alcohol for consumption on those premises, provided that the audience does not exceed 500.
 - o any playing of recorded music between 08.00 and 23.00 on any day, in a church hall, village hall, community hall, or other similar community premises, that is not licensed by a premises licence to sell alcohol, provided that (a) the audience does not exceed 500, and (b) the organiser gets consent for the performance from a person who is responsible for the premises.
 - o any playing of recorded music between 08.00 and 23.00 on any day, at the non-residential premises of (i) a local authority, or (ii) a school, or (iii) a hospital, provided that (a) the audience does not exceed 500, and (b) the organiser gets consent for the performance on the relevant premises from: (i) the local authority concerned, or (ii) the school proprietor or (iii) the health care provider for the hospital.

Continued from previous page...

- Dance: no licence is required for performances between 08.00 and 23.00 on any day, provided that the audience does not exceed 500. However, a performance which amounts to adult entertainment remains licensable.
- Cross activity exemptions: no licence is required between 08.00 and 23.00 on any day, with no limit on audience size for:
 - o any entertainment taking place on the premises of the local authority where the entertainment is provided by or on behalf of the local authority;
 - o any entertainment taking place on the hospital premises of the health care provider where the entertainment is provided by or on behalf of the health care provider;
 - o any entertainment taking place on the premises of the school where the entertainment is provided by or on behalf of the school proprietor; and
 - o any entertainment (excluding films and a boxing or wrestling entertainment) taking place at a travelling circus, provided that (a) it takes place within a moveable structure that accommodates the audience, and (b) that the travelling circus has not been located on the same site for more than 28 consecutive days.

Section 21 of 21

PAYMENT DETAILS

This fee must be paid to the authority. If you complete the application online, you must pay it by debit or credit card.

Premises Licence Fees are determined by the non-domestic rateable value of the premises.

To find out a premises non domestic rateable value go to the Valuation Office Agency site at http://www.voa.gov.uk/business_rates/index.htm

Band A - No RV to £4300 £100.00

Band B - £4301 to £33000 £190.00

Band C - £33001 to £8700 £315.00

Band D - £87001 to £12500 £450.00*

Band E - £125001 and over £635.00*

*If the premises rateable value is in Bands D or E and the premises is primarily used for the consumption of alcohol on the premises then you are required to pay a higher fee

Band D - £87001 to £12500 £900.00

Band E - £125001 and over £1,905.00

There is an exemption from the payment of fees in relation to the provision of regulated entertainment at church halls, chapel halls or premises of a similar nature, village halls, parish or community halls, or other premises of a similar nature. The costs associated with these licences will be met by central Government. If, however, the licence also authorises the use of the premises for the supply of alcohol or the provision of late night refreshment, a fee will be required.

Schools and sixth form colleges are exempt from the fees associated with the authorisation of regulated entertainment where the entertainment is provided by and at the school or college and for the purposes of the school or college.

If you operate a large event you are subject to ADDITIONAL fees based upon the number in attendance at any one time

Capacity 5000-9999 £1,000.00

Capacity 10000 -14999 £2,000.00

Capacity 15000-19999 £4,000.00

Capacity 20000-29999 £8,000.00

Capacity 30000-39000 £16,000.00

Capacity 40000-49999 £24,000.00

Capacity 50000-59999 £32,000.00

Capacity 60000-69999 £40,000.00

Capacity 70000-79999 £48,000.00

Capacity 80000-89999 £56,000.00

Capacity 90000 and over £64,000.00

* Fee amount (£)

190.00

DECLARATION

Continued from previous page...

I/We understand that it is an offence, under section 158 of the Licensing Act 2003, to make a false statement in or in connection with this application. Those who make a false statement may be liable on summary conviction to a fine of any amount.

[Applicable to individual applicants only, including those in a partnership which is not a limited liability partnership] I understand I am not entitled to be issued with a licence if I do not have the entitlement to live and work in the UK (or if I am subject to a condition preventing me from doing work relating to the carrying on of a licensable activity) and that my licence will become invalid if I cease to be entitled to live and work in the UK (please read guidance note 15).

The DPS named in this application form is entitled to work in the UK (and is not subject to conditions preventing him or her from doing work relating to a licensable activity) and I have seen a copy of his or her proof of entitlement to work, if appropriate (please see note 15)

The information provided will be held securely by this Council in accordance with current Data Protection legislation. We must protect the public funds that we handle, so we may use the information provided to prevent and detect fraud. We may also share this information with other organisations that handle public funds. Information provided may also be used to check the accuracy of records held elsewhere in the council. See www.southhams.gov.uk for further information.

Ticking this box indicates you have read and understood the above declaration

This section should be completed by the applicant, unless you answered "Yes" to the question "Are you an agent acting on behalf of the applicant?"

* Full name

* Capacity

* Date / /
dd mm yyyy

Once you're finished you need to do the following:

1. Save this form to your computer by clicking file/save as...
2. Go back to <https://www.gov.uk/apply-for-a-licence/premises-licence/south-hams/apply-1> to upload this file and continue with your application.

Don't forget to make sure you have all your supporting documentation to hand.

IT IS AN OFFENCE LIABLE TO SUMMARY CONVICTION TO A FINE OF ANY AMOUNT UNDER SECTION 158 OF THE LICENSING ACT 2003, TO MAKE A FALSE STATEMENT IN OR IN CONNECTION WITH THIS APPLICATION

IT IS AN OFFENCE UNDER SECTION 24B OF THE IMMIGRATION ACT 1971 FOR A PERSON TO WORK WHEN THEY KNOW, OR HAVE REASONABLE CAUSE TO BELIEVE, THAT THEY ARE DISQUALIFIED FROM DOING SO BY REASON OF THEIR IMMIGRATION STATUS. THOSE WHO EMPLOY AN ADULT WITHOUT LEAVE OR WHO IS SUBJECT TO CONDITIONS AS TO EMPLOYMENT WILL BE LIABLE TO A CIVIL PENALTY UNDER SECTION 15 OF THE IMMIGRATION, ASYLUM AND NATIONALITY ACT 2006 AND PURSUANT TO SECTION 21 OF THE SAME ACT, WILL BE COMMITTING AN OFFENCE WHERE THEY DO SO IN THE KNOWLEDGE, OR WITH REASONABLE CAUSE TO BELIEVE, THAT THE EMPLOYEE IS DISQUALIFIED

OFFICE USE ONLY

Applicant reference number	Bearz Bar - The Kidz & Co
Fee paid	
Payment provider reference	
ELMS Payment Reference	
Payment status	
Payment authorisation code	
Payment authorisation date	
Date and time submitted	
Approval deadline	
Error message	
Is Digitally signed	<input type="checkbox"/>

< Previous 1 2 3 4 5 6 7 8 9 10 11 12 13 14 15 16 17 18 19 20 21 Next >

This page is intentionally left blank

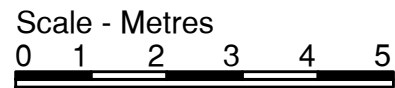

LICENSING KEY

Licensable activities

NOTES:
Items shown on this plan which are not part of the statutory requirements are shown for indicative purposes only. This would include loose or fixed furniture in certain circumstances, the position of toilet cubicles, CCTV cameras and fire safety equipment not specified in the Regulations. These are shown upon the plans for illustrative purposes only and may be moved at the discretion of the license holder.

The current location of fire safety equipment and other safety equipment is shown. These may be subject to variation in the future as necessary and where applicable in liaison with the Fire Officer.

Page 31

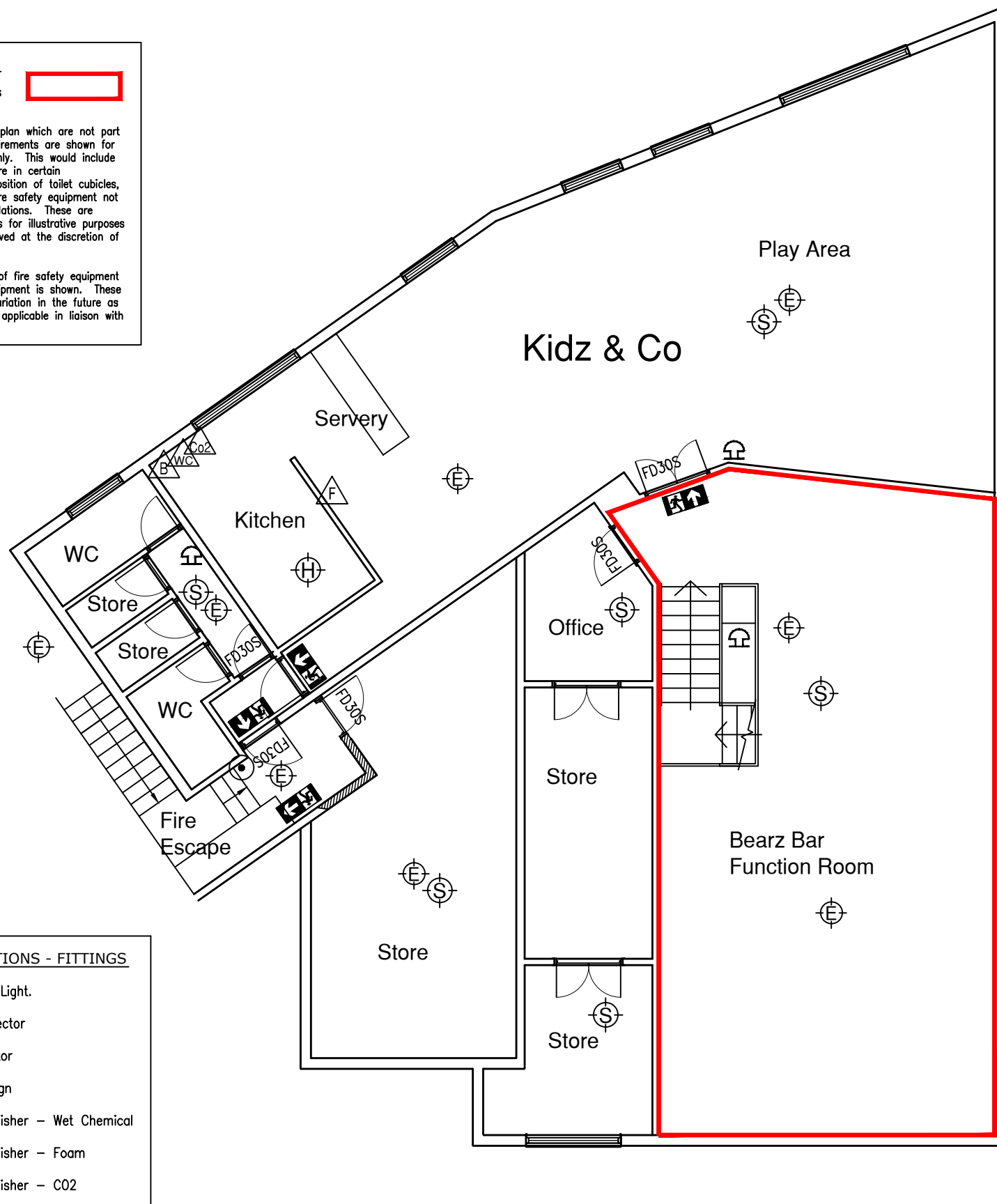

First Floor Plan

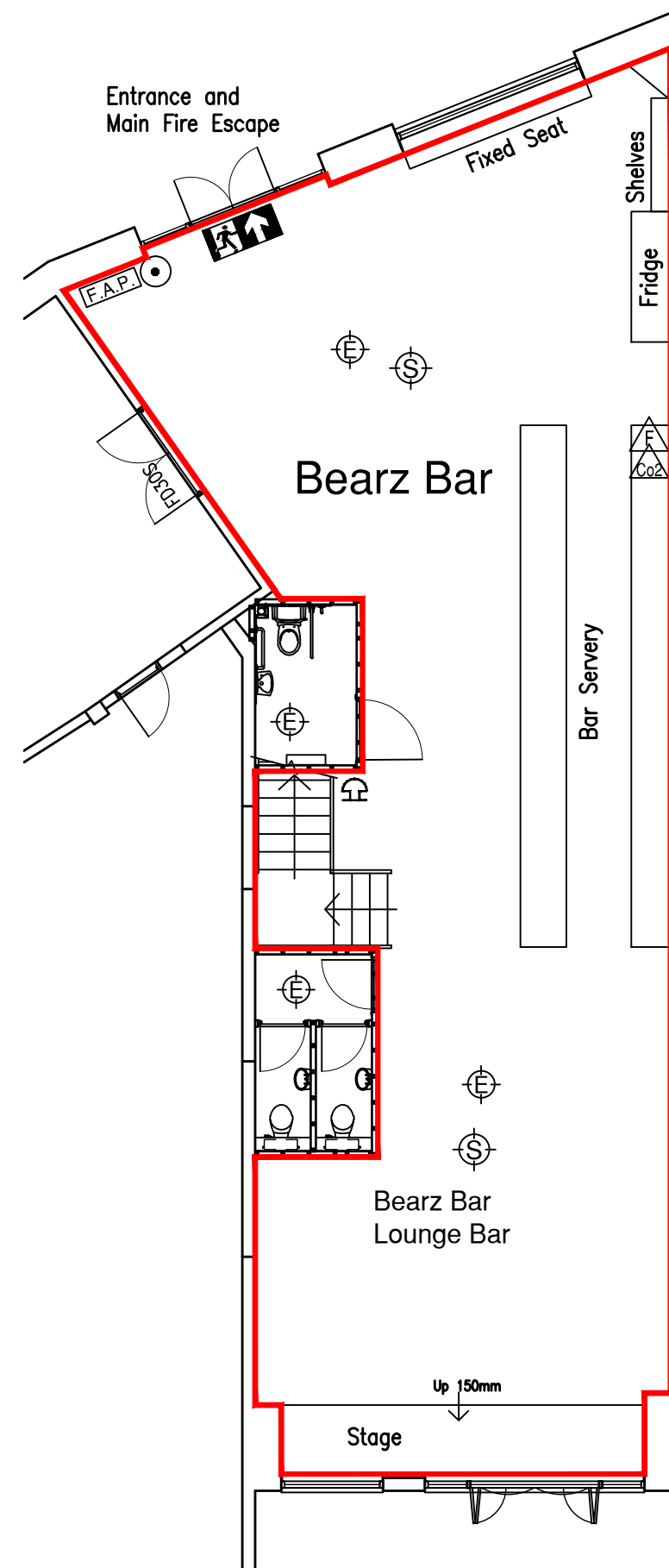

Ground Floor Plan

FIRE PRECAUTIONS - FITTINGS

- Emergency Light.
- Smoke Detector
- Heat Detector
- Fire Exit Sign
- Fire Extinguisher - Wet Chemical
- Fire Extinguisher - Foam
- Fire Extinguisher - CO2
- Fire Blanket
- Alarm Call Point
- FD30S 'Fire Door - Keep Shut' sign.
- Alarm Sounder
- Fire Alarm Panel

NOTES

This drawing is the copyright of DESIGN COALITION and cannot be reproduced in any form without the written consent of the company. Written and scaled dimensions to be checked on site, and any discrepancies reported prior to work commencing. IF IN DOUBT PLEASE ASK

REVISIONS

REV DATE BY DESCRIPTION

THE OLD MILL, CASTLE STREET
ONGAR, ESSEX CM5 9JY
TELEPHONE (01277) 388000
E MAIL FIRSTNAME@DESIGNCOALITION.CO.UK



PROJECT

Bearz Bar
Island Street, Salcome

CLIENT

The Kidz and Co

TITLE

Floor Plans
Proposed Layouts
Licensing Plan

DATE	DRAWN	SCALE (A3 Size)
Jan 18	EAL	1:100

DRAWING NUMBER	REVISION
2811-103	

This page is intentionally left blank

Bearz Bar – amendments and additional conditions agreed with the police

Hours for supply of alcohol:

Monday to Sunday from 10:00 to 23:00 (current application Mon to Sun 10:00 to 23:30)

Opening hours:

Monday to Sunday from 08:00 to 23:30 (current application Mon to Sun 10:00 to 00:00)

THE PREVENTION OF CRIME AND DISORDER

1. All drinks to be served in toughened glass and to be cleared from public areas when finished or empty.
2. No bottles to be served that any person may have the intention to drink from.
3. Service will be by waiter /waitress to persons seated at tables and food to be made available during trading hours.
4. No drinks to be consumed outside the front of the premises.
5. If numbers attending any function exceeding 100 persons there will be an invited list and 2 SIA door staff should be employed for the event.
6. If any 18 to 21 birthday celebrations are held on the premise then 2 x door staff shall be employed for the event.

THE PROTECTION OF CHILDREN FROM HARM

1. Any person under the age of 18 must be accompanied by a responsible adult from 7.00pm onwards.

This page is intentionally left blank

①

RECEIVED
19 FEB 2018

Sir,

I wish to object to the licensing application by Bearz Bar, The Kidz and Co, Island Street, Salcombe, TQ8 8DP.

As a resident of Island Street I feel the amount of noise, antisocial behaviour and property damage caused by the patrons of the Island Street Bar And Grill is already unbearable, especially between the hours of 10.00pm and 1.00am. Licensing yet another bar is only going to make situation worse.

[REDACTED]

[REDACTED]

[REDACTED] Island Street
Salcombe
TQ8 8DP
Ph: [REDACTED]

RECEIVED

09 FEB 2018

[REDACTED]
Cliff Road,
Salcombe,
Devon. TQ8 8LD

[REDACTED]
Tel: [REDACTED]

The Licensing Department,
South Hams District Council,
Follaton House,
Plymouth Road,
Totnes. TQ9 5NE

6 February 2018

Dear Sirs

Premise Licenses - Kids and Co (Bearz Bar), Island Street Salcombe TQ88DP

I should like to support those who live in Island Street and the many residential properties to the West and South of Kids and Co / the proposed Bearz Bar, particularly those within the boundary set by Shadycombe and Gould Roads, and caution against licensing another premise in Island Street for alcohol and music.

Island Street has served light industrial units (principally boat building / repair / sales) on its North side (which fronts onto Batson Creek), and Residential dwellings to the South for 100 years or more. Whilst there has been considerable local opposition to the gradual change of the North side of the road from marine related industrial units to retail, this has had limited impact on the residential properties, as the change of use has not resulted in noise or other nuisance – with the exception of that from the bar in Hannaford's Landing. The licensing of another of these units to permit the sale of alcohol [for consumption both on and off premises all day (10 am to 1130 pm)] and live / recorded music from morning (10am on Sundays!) to late evening is, however, quite another matter. Each of these has the potential to impact significantly on the ability of residents to enjoy without interruption, not only their gardens, but also their rooms facing onto Island Street which will have to have windows closed at night due to the noise / activity outside. The Licensing Department will be extremely familiar with the range of noise pollution generated by such premises, particularly where alcohol and music are combined, and their incompatibility with residential areas.

More generally, the application raises the question of the benefits to the town of yet another business encouraging the consumption of alcohol, on and off the premises, throughout the day and well into the evening/night. Salcombe already has ample outlets for the sale and consumption of alcohol – in addition to the new Co-Op which is soon to open just around the corner from Kids & Co. I suggest the last thing needed is further easy access to alcohol which can (and will) then be drunk in the streets (contrary to local by-laws) and other public areas.

I recommend that, when this application is considered, the need for and benefits of such a venue are weighed carefully against the negative impact on both the town and neighbouring residential properties.

Yours faithfully,
[REDACTED]

3

RECEIVED

67 FEB 2018

[REDACTED]
Gould Road

Salcombe

TQ8 8DU

The Licensing Department
South Hams District Council
Follaton House
Plymouth Road
Totnes
TQ9 5NE

Monday 5th February 2018

Dear Sir/Madam,

**Alcohol, Live and Recorded Music Application – Bearz Bar, The Kidz and Co,
Island Street, Salcombe TQ8 8DP**

I write with reference to the above application, to which I wish to register my objection.

The Gould Road end of Island Street is a quiet mixed street of daytime retail, offices and residential housing. It is not a part of Salcombe's night time economy.

The proposed application is for the sale of alcohol and for live and recorded music as late as 11-30 or midnight which, if the application is approved, will undoubtedly have a detrimental impact upon local residents through increased noise levels late at night. It is for this reason that I am objecting.

Yours sincerely

[REDACTED]

[REDACTED]

4

RECEIVED
06 FEB 2018

[REDACTED]

Island St, Salcombe,

TQ8 8DT

I am writing to express very strong objections to the application put forward by Kidz & Co who have their premises opposite us. This is a largely residential area that has already had to put up with vastly increased noise and people due to the moving in to the area of many more retail shops. This Island st area, I understood, was supposed to consist mainly of marine related small commercial businesses but seems to be becoming a drinking area.

The noise created by the music and drinking license being granted will potentially make the area a very unpleasant place to live – music all day, sale of alcohol all day and, of particular concern, is that any smokers will carry out their smoking, no doubt after several drinks, directly on the street which could, potentially, be dangerous, & be chatting loudly there without any consideration to the people trying to sleep. Our bedroom window, and those of our neighbours, are only about 30 yds away! Noise carries, particularly upwards so the number of homes & people affected will be wide and numerous.

I urge you to consider very carefully the ramifications of granting such an 'open' i.e. all hours, license to Kidz & Co.

Yours

[REDACTED]

5

15 FEB 2018

Wraxall
Bristol
BS48 1ND

The Licensing Manager
South Hams District Council
Follaton House
Plymouth Road
Totnes
Devon
TQ9 5NE

13 February 2018

Dear Sirs

Re Licencing Act 2003 Application: Bearz Bar, The Kidz and Co, Island Street, Salcombe, TQ8 8DP from The Kidz and Co.

- We are writing to register our objection to the above application for a premises licence for:
- Live music: Mon-Thurs from 3pm to 11pm; Fri from 3pm to 11.30pm; Sat from 12pm to 11.30pm; Sun from 10am to 11pm.
- Recorded music: Mon-Sun from 8am to midnight.
- Sale of alcohol for consumption on and off the premises: Mon-Sun from 10am to 11.30pm.

The basis of this objection is that granting a licence will not promote the licencing objectives of Prevention of Crime and Disorder, Prevention of Public Nuisance, Protection of Children from Harm and Public Safety, and further more is inconsistent with Island Street's inclusion in the Conservation Area under the Salcombe Conservation Area Appraisal adopted by South Hams District Council in February 2010. Specifically:

Prevention of Crime and Disorder	The application proposes that alcohol may be sold for consumption both on and off the premises for a continuous period of 13 hours from 10am to 11:30pm. Granting a licence would provide a further source of alcohol within Salcombe which is heavily populated with licensed premises that crime, disorder and public nuisance have already reached problem levels. Furthermore the granting of a licence would extend the problems to the perimeter of Salcombe.
Prevention of Public Nuisance	Music for up to 16 hours a day from 8am will have a detrimental effect on the residents of the area. Noise will not be contained within the premises, which is of inadequate construction to prevent noise arising from crowds and recorded and live music impacting the surrounding area, which includes Chandlers, the residential retirement home. Furthermore, people coming out to smoke will add further noise and associated litter. The area already suffers from antisocial noise and behaviour from those returning home after drinking in the centre of Salcombe, to grant a licence would significantly add to the problem.

Protection of Children from Harm	The granting of an all-day alcohol and music licence would appear wholly incompatible with the other use for part of the premises as a crèche. The area is visited by a lot of children, with the Salcombe Dairy ice cream factory shop outside seating areas immediately overlooking the proposed licenced premises.
Public Safety	The premises exit immediately onto a busy public road, in constant use during by both businesses – including vehicles towing trailers - and the general public. There are frequently vehicles reversing immediately in front of the premises to allow vehicles to exit from the narrow section of Island Street, which would present a significant danger to those exiting from the proposed licenced premises.
Conservation Area	The Salcombe Management Plan states: <i>"Area around Island Street and Shadycombe After consideration and consultation, Island Street, part of Gould Road and Croft Road and the Shadycombe Cemetery are now included in the conservation area. The Island Street area is typified by boatbuilding activities that are of historic importance to the town (even though this area was reclaimed relatively recently). This is one of the main approaches to the town and is an important introduction to its character. The rest of the area is an attractive 18th and 19th century extension to the town in an attractive setting. Users and residents of this area were consulted on whether they wished to be included or not and no objections were registered."</i> To turn a premises that has historically been utilised by businesses to support the water based activities around Salcombe into a licenced premises would appear to be completely at odds with the objectives set out in the Management Plan noted above.

In view of the above we would urge the Licencing Authority to refuse the above application.

Yours faithfully

For and on behalf of [REDACTED] owners of

[REDACTED]

[REDACTED]

Email: [REDACTED]

6

Tel: [REDACTED] Mob: [REDACTED]

Email: [REDACTED]

The Licensing Department
South Hams District Council
Follaton House
Plymouth Rd
Totnes
TQ9 5NE

15th Feb 2018

Dear Sirs,

A4 License application at Kidz & Co/ Bearz Bar, Island St Salcombe TQ8 8DP.

As a resident of Island street, I would like to register my objection to the proposed application for an A4 Drinking establishment license for the above premises. My representations relate to numbers 2,3 and 4 of your objectives for granting such a license.

The area of Gould Rd, Shadycombe Rd and Island St which will be affected by this proposal for an all day, all week, drinking and music bar, are in the local Conservation Area which is intended not only to preserve the appearances of the buildings/area, but to also preserve the general character and ambience of the area. This area of Island St is the start of the main thoroughfare into Salcombe town centre for all visitors walking from the car parks into town. Salcombe Town Council has stated that ' This is one of the main approaches to the town and is an important introduction to its character '

Shadycombe Rd and Gould Rd are mainly residential and Island St is a mix of residential, mostly on the south side and mixed residential, light industrial, (small marine based businesses) and small retail units on the north side. These commercial units are harmonious with the area and do not cause, with the exception of The Gin Bar and the Island St Bar, any disruption or noise/antisocial problems to the local residents. The introduction of an all day drinking/music establishment in this position will severely change the nature of the area for the worse.

Objective 2

The narrow exit from the premises opens directly onto the highway and poses a real possibility of somebody, possibly inebriated, stepping directly into the path of an oncoming vehicle/cyclist especially with the advent of silent electric cars.

The premises is of mainly timber construction internally and, in the case of a fire, a large crowd attending a live music show would encounter serious problems exiting the building safely through the restricted doorway.

Objective 3

It is difficult to imagine a premises and location which is less suited to an all day, all week music and drinking bar.

There is no community need for such a venue in this location as there are, already mentioned, two such establishments within three hundred yards of these premises and also less than 100 yards away, at the end of Island St there is shortly to open a Co-op which will

provide off license services.

Deliveries and collections of food, alcohol etc and musicians loading/unloading their equipment throughout the day will cause severe disruption in this narrow road as they will inevitably block the road to vehicles and pedestrians alike trying to get into town along this main route.

The question of waste and where it will be stored/disposed of with the associated problem with vermin must be addressed, as must the noise generated by the daily disposal of large quantities of beer bottles etc.

There is no area provided on the premises for smoking and therefore it is inevitable (even if asked not to) that crowds of smokers will congregate on the highway around the doorway creating a nuisance of noise late at night and litter with fag ends, fag packets and beer bottles being left in the road, and also creates a road safety issue. It is also against the local bye-laws to drink alcohol in the street, but this will inevitably happen.

The impact of the noise nuisance upon the local residents and visitors, from the premises playing music from 8am -midnight with the drinking bar serving from 10am-11.30pm every day, with rowdy groups of customers arriving and then leaving, also late at night, cannot be underestimated and will have a serious detrimental effect on the ambience of the Conservation area and the residents quality of life. Residents should have the right to enjoy sitting in their front gardens but, the inevitable noise nuisance from this venue will severely restrict their ability to do so.

Objective 4

The applicant has stated that she wishes to keep the present creche/childrens play area in the upstairs part of the building, but this is totally incompatible with an all day drinking/music bar downstairs.

On a general note, The applicant has stated (see attached copy of notice in premises window)that the intention for the application is to enable her to have tables to serve food and wine to, but if that is the case then surely an A3 Restaurant/cafe license would be the appropriate license.

The A4 license, if granted goes with the building and is permanent, and so ,even if the stated intentions are accurate at present, then they can be changed at any time in the future without the need for any further application or consultation.

I sincerely hope that the Committee will carefully consider the fact that the only person benefiting from the granting of this license is the applicant and weigh that against the severe detrimental impact that it will have on the area, local residents and the image of the town alike.

If the licence is granted can I suggest that the Committee make it subject to a limit on the permitted noise level, both within and without the premises.

Thank you for considering this objection.

Yours sincerely

[Redacted signature]

[Redacted address]

For Interested Parties Regarding The Kidz & Co/ Bearz Bar
License Application

We are applying for an Alcohol and Music License for the new Bearz Bar, not The Kidz & Co Soft Play Café Upstairs. No Alcohol is to be consumed or bought in The Play Café.

Bearz Bar is being created into a Lounge bar/ Restaurant, with a license to suit this purpose. This is not a 'drinking bar' but a Restaurant. Tables will be waited on and drinks will be served to seated guests at the tables.

We shall occasionally have light jazz, acoustics, bands and vocals to accompany people's meals. All of which shall be performed at the rear of the building away from residential areas.

Everyone/anyone who wishes to smoke will be directed towards the crossroads away from residential areas. Any groups seen to be congregating near the entrance, or near any residential properties shall be asked to be moved on.

No glasses or open drinks are allowed out of Bearz Bar.

Our license application's alcohol service time has been altered to 11pm to ensure that all customers shall be out of the premises by 11.30pm.

Although not in our application, we have come to an in-house decision that Bearz Bar shall not host any birthday party bookings for anyone under the age of 21 and we will be very scrupulous when requiring adequate I.D for anyone who appears under 25 years of age.

I am more than happy to discuss any queries or concerns regarding this license application and if you do wish to get in touch please do so at info@thekidzandco.com or 07787686727

Signed,



Miss Corinne Lynn, Proprietor

7

Naomi Stacey

From: [REDACTED]
Sent: 15 February 2018 03:42
To: SW-Licensing
Subject: Kidz and Co licence application for Bearz Bar Salcombe

We are writing to register our very strong objections to the application from Kidz and Co for Bearz Bar in respect of a licence for live and recorded music and sale and consumption of alcohol We live full time (this is our only residence) within approximately 20 metres of the premises. We are obviously very concerned about the noise levels, anti social behaviour and increased cooking smells.

We are particularly concerned regarding smokers standing outside the building in the road - please note there is no pavement, therefore a potential traffic hazard. There is no other outside area for smokers, unlike the Bar and Grill. Noise travels, generally upwards, therefore we will be directly affected living so close on a higher level (our ground floor is level with their first floor) The lack of pavement indicates that revellers, with or without the influence of alcohol will be stepping right out into the road, very near a junction.

We would like confirmation that the sound proofing of the building will be adequate and conform to regulations. The doors will almost certainly be open in the summer for ventilation. We cannot envisage how this old boat shed can be sound proofed.

Island Street was designated as the Marine Quarter and this application appears to be a contradiction of this. It is also a residential area - is it now to be designated a noisy all day drinking area ?

Access from Shadycombe car park is via some very steep, poorly lit steps adjacent to our property. Another potentially dangerous and noisy aspect from young intoxicated revellers.

We have no permanent Police presence and are very concerned regarding the time it will take for Police response in the inevitable event of trouble and underage all day drinking.

We are experiencing excessive cooking smells all day which will obviously increase with the extended opening hours.

We would like confirmation of installation of suitable ventilation to comply with regulations We are concerned regarding the conflict of the sale of alcohol in such close proximity to the children's soft play area, even though the application is put forward as a separate business, they are all together in the same building.

We have run businesses in Salcombe since the Eighties and understand how hard it is to maintain trade all year round. However, it can be done successfully without compromising the quality of neighbouring residents' lives We urge you to carefully consider the ramifications of this application Yours [REDACTED]

[REDACTED]
Island Street
Salcombe
TQ8 8DT

8

Naomi Stacey

From: [REDACTED]
Sent: 15 February 2018 08:48
To: SW-Licensing
Subject: Kidz&co got Bearz Bar licensing request

Dear Sir,

I am writing to strongly object to the proposed licensing of the Kidz&Co premises.

I live diagonally opposite the premises in [REDACTED] Gould Road. Approximately 50 metres away as the crow flies.

As a Salcombe resident this will not enhance our town. Another place where revellers can impact negatively on the ethos of the town will not enhance our reputation for most holiday makers let alone for those of us who live here.

I cannot believe that health and safety issues will not come to the fore. The premises opens straight on to Island Street, there is no path and a narrowing of the road, surely a potential RTA risk.

People coming out of the bar to smoke will only cause a nuisance let alone air pollution. Already I have noticed cooking fumes coming from the premises. If I can smell this from my house, it must be most intrusive for those overlooking the premises.

Island Street was designated as a street for industry related to boating and fishing. It is hard to reason how this request for a former boat related store to be turned into a bar is acceptable.

For me personally, the issue of noise will impact on my quality of living. It is already chronic in high season. To have another potential partying area with more youngsters congregating in the vicinity, smoking and drinking in the top of island Street and spilling into Shadycombe car park is not acceptable.

Please think carefully and let sense prevail over any economic advantage to this request.

Yours faithfully,

[REDACTED]

9

Naomi Stacey

From: Cllr S. Wright
Sent: 20 February 2018 10:28
To: Naomi Stacey; Cllr J. Pearce
Cc: Cllr D. May
Subject: RE: New premises licence application - Bearz Bar, Salcombe

Dear Naomi,

I sincerely hope you are able to reach an agreement between all parties.

I feel the idea this premises could be turned into a night club has perhaps raised the profile of this application.

I do however have concerns over possible access into the Play Space area. There are obvious serious implications during the day but I also feel uncomfortable for any access in the evenings.

Noise levels can and I am sure will be addresses.

Access into Island Street is poor and while acceptable for most uses. We may experience addition safety issues should smokers be allowed to accumulate in and around the doorway. I quite understand this is an issue that could arise with any activity within the building but is more likely outside a licenced premises. I would like to see this mitigated in some way.

I hope my comments have been useful.

Kind regards,

Cllr Simon Wright

Ward Member: Salcombe and Thurlestone

Deputy Leader and Executive lead for Support Services

South Hams District Council

Tel: [REDACTED]
[REDACTED]

10

Naomi Stacey

From: [REDACTED]
Sent: 20 February 2018 18:37
To: SW-Licensing
Subject: Bears Bar / Kidz & Co Salcombe

Sir/madam

I wish to object to the application for a licensed premises with live and recorded music at the above premises.

My reasons for objecting are as follows:

1. Noise and anti social behaviour/Crime and Disorder

The premises are in a residential area which will suffer anti social behaviour, noise from people inside, arriving and departing the premises (under the influence of alcohol) and undue noise from the proposed live and recorded music until midnight. Noise will carry and given the business is likely seasonal windows and doors will need to be left open to enable ventilation where there are a condensed number of people in summer months exacerbating the noise. The premises are in a neighbourhood resided by elderly people (Chandlers Heights) and families who reside all year round. The noise will be worse if houses have windows open. Island street bar, is at least set back several meters from houses but the noise from this bar is bad enough! The noise created by Bearz Bar will be unbearable for residents including children who have to attend school.

Smoking will be out in the street further increasing the noise issue. There is no outdoor space for this activity other than on the street directly outside and this too will be anti social for families passing by.

2. Risk of road accident public safety & vehicles

The premises front access/egress is directly onto the road at Island Street which in addition to being a busy thoroughfare is required for lorries making deliveries. Vehicles regularly have to reverse long distances in the area due to holdups and obstruction. Persons exiting the bar will be put at risk from the direct access to the road. Fishing stores with trucks loaded with pots, boats with long trailers towing behind are all going to be put at risk of collision by adults under the influence of alcohol emerging from the premises or hanging around outside for fresh air as there is no dedicated outdoor space. The rest of the premises goes directly into the estuary making ventilation difficult.

3. Protection of children - is a kids play zone conducive to drinking alcohol and associated activities especially with an ice cream shop opposite?

4. Inside Conservation Area ... another bar is not conducive to benefit of the town.

5. Direct quote from Salcombe Management plan

"Area around Island Street and Shadycombe After consideration and consultation, Island Street, part of Gould Road and Croft Road and the Shadycombe Cemetery are now included in the conservation area. The Island Street area is typified by boatbuilding activities that are of historic importance to the town (even though this area was reclaimed relatively recently). This is one of the main approaches to the town and is an important introduction to its character. The rest of the area is an attractive 18th and 19th century extension to the town in an attractive setting. Users and residents of this area were consulted on whether they wished to be included or not and no objections were registered. "

Is a licensed premises acceptable in regards to the Management plan? (introduction to its character). The other Licensed Premises in Island St, Island St Bar and Grill and The Salcombe Gin Distillery, are both set off the road, away from the public and children, with areas out the back for Smokers and the like.

6. New residences currently being built in nearby Gould Road are regenerating the area and permitting a licensed premises in this area is wholly inappropriate because of the reasons stated above - the residents will suffer adversely and as the character of Island Street needs to be preserved for maritime and light industrial use and as a main thoroughfare into Salcombe from the main car park will not make a good impression on visitors passing by.

As a resident who has resided a stones throw from this location for 26 years, I strongly oppose the grant of a license.

Yours sincerely

A black rectangular redaction box covering the signature of the sender.

Shadycombe Road
Salcombe
Devon
TQ8 8NS



Naomi Stacey

From: [REDACTED]
Sent: 12 February 2018 18:16
To: SW-Licensing
Subject: Objection

Live Music, Recorded Music, Sale and Consumption of Alcohol Licence Application
Bearz Bar, The Kidz and Co, Island Street, Salcombe TQ8 8DP

I object to the above on the grounds:

1. **Public Safety:** sited on busy service road to boat workshops, opposite holiday home office servicing point and Salcombe Dairy where there is already vehicular and pedestrian congestion. This point in the road is presently dangerous as narrow Island Street is effectively one way and lorries, towed boats and cars have to reverse into this space to permit thoroughfare.
2. **Public Nuisance:** disruption to adjacent sheltered and private housing.
3. **Conflict** with existing Kidz Soft Play Cafe and crowds of holidaying children.
4. **Usage:** contrary to the Salcombe Management Plan.

[REDACTED]

12

Naomi Stacey

From: [REDACTED]
Sent: 08 February 2018 13:06
To: SW-Licensing
Subject: Bears Bar, Salcombe

[REDACTED] Berry Close

Salcombe

TQ8 8BP

I am writing to register my objections to the proposed granting of a music and alcohol licence for Bearz Bar in Island Street, TQ8 8DP.

1. I believe it is still unlawful to be in charge of a child under the age of 5 years whilst intoxicated and as Bearz Bar proposes to have a soft play area for under sevens at the same venue as the bar I presume parents/carers will be able to purchase and drink alcohol whilst their charges play.
2. I understood that Island Street premises were to be reserved for marine related businesses but it already houses some general retail premises along with two businesses supplying alcohol and one with a music licence so why do we need another such business in a relatively short road. Salcombe is quite well serviced with public houses and restaurants already.
3. We are being advised that the consumption of alcohol in the whole country exceeds guidelines should we be offering even more temptation?
4. Alcohol consumption is well known to exacerbate bad conduct and as we have no police presence in Salcombe it would take at least an hour for the police to arrive from Paignton to quell any trouble.
5. Where you have music, alcohol and, I presume, dancing the noise levels will be pretty high and as Bearz Bar is very close to residential properties it will be very disturbing for the residents in particular Chandlers Heights which houses several elderly people who tend to go to bed early. Noise travels further near water. In the summer the doors to the street would undoubtedly be open for ventilation and for those who smoke to party outside.

Kind regards

[REDACTED]

13

Naomi Stacey

From: [REDACTED]
Sent: 20 February 2018 21:10
To: SW-Licensing
Subject: Fwd: Bears Bar / Kidz & Co Salcombe

> Sir/madam

>>

>> I wish to object to the application for a licensed premises with live and recorded music at the above premises.

>>

>> My reasons for objecting are as follows:

>>

>> 1. Noise and anti social behaviour/Crime and Disorder

>>

>> The premises are in a residential area which will suffer anti social behaviour, noise from people inside, arriving and departing the premises (under the influence of alcohol) and undue noise from the proposed live and recorded music until midnight. Noise will carry and given the business is likely seasonal windows and doors will need to be left open to enable ventilation where there are a condensed number of people in summer months exacerbating the noise. The premises are in a neighbourhood resided by elderly people (Chandlers Heights) and families who reside all year round. The noise will be worse if houses have windows open. Island street bar, is at least set back several meters from houses but the noise from this bar is bad enough! The noise created by Bearz Bar will be unbearable for residents including children who have to attend school.

>>

>> Smoking will be out in the street further increasing the noise issue. There is no outdoor space for this activity other than on the street directly outside and this too will be anti social for families passing by.

>>

>> 2. Risk of road accident public safety & vehicles

>>

>> The premises front access/egress is directly onto the road at Island Street which in addition to being a busy thoroughfare is required for lorries making deliveries. Vehicles regularly have to reverse long distances in the area due to holdups and obstruction. Persons exiting the bar will be put at risk from the direct access to the road. Fishing stores with trucks loaded with pots, boats with long trailers towing behind are all going to be put at risk of collision by adults under the influence of alcohol emerging from the premises or hanging around outside for fresh air as there is no dedicated outdoor space. The rear of the premises goes directly into the estuary making ventilation difficult.

>>

>> 3. Protection of children - is a kids play zone conducive to drinking alcohol and associated activities especially with an ice cream shop opposite?

>>

>> 4. Inside Conservation Area ... another bar is not conducive to benefit of the town.

>>

>>

>>

>>

>> 5. Direct quote from Salcombe Management plan

>>

>> "Area around Island Street and Shadycombe After consideration and consultation, Island Street, part of Gould Road and Croft Road and the Shadycombe Cemetery are now included in the conservation area. The Island Street area is typified by boatbuilding activities that are of historic importance to the town (even though this area was reclaimed relatively recently). This is one of the main approaches to the town and is an important introduction to its character. The rest of the area is an attractive 18th and 19th century extension to the town in an attractive setting. Users and residents of this area were consulted on whether they wished to be included or not and no objections were registered."

>>

>>

>>

>> Is a licensed premises acceptable in regards to the Management plan? (introduction to its character). The other Licensed Premises in Island St, Island St Bar and Grill and The Salcombe Gin Distillery, are both set off the road, away from the public and children, with areas out the back for Smokers and the like.

>>

>>

>> 6. New residences currently being built in nearby Gould Road are regenerating the area and permitting a licensed premises in this area is wholly inappropriate because of the reasons stated above - the residents will suffer adversely and as the character of Island Street needs to be preserved for maritime and light industrial use and as a main thoroughfare into Salcombe from the main car park will not make a good impression on visitors passing by.

>>

>> As a resident who grew up here and will be directly and adversely impacted inside my home by the activity, particularly noise. And as a crab fisherman, manoeuvring & driving to load my pots and rope from my fishermans store three doors away at 6 Island Street I strongly oppose the grant of a license for all the reasons stated above.

>>

>>

>> Yours sincerely

>>

>>

>>

>> Shadycombe Road

>> Salcombe

>> Devon

>> TQ8 8NS

14

Naomi Stacey

From: Town Clerk <townclerk@salcombetowncouncil.gov.uk>
Sent: 20 February 2018 18:22
To: Naomi Stacey
Cc: [REDACTED]
Subject: RE: New premises licence application - Bearz Bar, Salcombe

Dear Naomi,

There was an attendance from member of the public at full council along with emails previous to this meeting and thus the below was Minuted. The general feedback was great concern and thus an objection to this application.

Kindest.
Gill

The application by The Kidz and Co for new premises licences for Bearz Bar, Island Street was considered and it was AGREED to respond to District Council that town council objected as this was felt to enlarge what could be considered as an extended coffee shop to a noisy bar with soft play area upstairs. With the stairway situated halfway back through the property and the only toilets situated upstairs those using the facility would need to go up to access these toilets. With children around upstairs this was not felt to be compatible and conversely children and a bar for alcohol did not go together.

The entrance comprised of a single glaze plate glass window/door going out straight on to the highway with the back of the property bordered by a slipway. This side of Island Street was designated for employment but the other was residential including elderly residents at Chandlers Heights being close by. The valley then went up Coronation Road and with not much sound proofing within this property sound could be carried far. With a bar and small stage/area for a live band this did not leave a large amount of space for accessibility.

This was a full bar licence and potential for live music every day for this premises together with off sales and as such was felt far too extensive in this location. There was the added danger for customers exiting straight on to the highway and unacceptable interaction between drinkers and children.

It was questioned whether a Change of Use from A3 to A4 usage required a planning application but the District Councillor was not sure. Health and Safety concern was raised with regard to fire escapes in view of lack of back access and if the tide was in at the back, was the building fit for purpose.

15a

[REDACTED]
Island St
Salcombe
Devon
TQ8 8DP

Tel: [REDACTED]

Email: [REDACTED]

12th February, 2018

Dear Sirs

Bearz Bar, The Kidz and Co, Island Street, Salcombe, TQ8 8DP

As a resident, who lives across the Road from Kidz and Co, I am writing to register my objection to the application for a new premises licence by Kidz and Co. The basis for this opposition is that granting a licence is in contradiction with the licensing objectives.

Public Safety

- Entrance straight on to busy/working road
- Cars and Deliveries regularly have to reverse as so narrow
- Drop off and pick up of keys, for properties from Salcombe Holiday Homes (opposite)
- Thoroughfare from car parks to centre of Salcombe
- Boat maneuvering from Island Street workshops to boatpark/slipway/storage

Public Nuisance

- Noise, re late night licence, live music, music (earliest 10am, latest 11.30pm)
- Effect nearby residents, including Chandlers Heights (residential home)
- Smoking and Drinking on the road, even if monitored, will still happen

Protection of Children

- Creche and Bar incompatible in same premise

- Salcombe Dairy outside seating, children within earshot of licensed establishment with people drinking and the problems associated with it

Direct Quote from Salcombe Management Plan

“Area around Island Street and Shadycombe

After consideration and consultation, Island Street, part of Gould Road and Croft Road and the Shadycombe Cemetery are now included in the conservation area. The Island Street area is typified by boatbuilding activities that are of historic importance to the town (even though this area was reclaimed relatively recently). **This is one of the main approaches to the town and is an important introduction to its character.** The rest of the area is an attractive 18th and 19th century extension to the town in an attractive setting. Users and residents of this area were consulted on whether they wished to be included or not and no objections were registered.”

Is a licensed premises acceptable in regards to the Management Plan? (**introduction to its character**). The other licensed Premises in Island Street, ‘The Island Street Bar and Grill’ and ‘The Salcombe Gin Distillery’, are both set back off the road, away from the public and children, with areas out the back for smokers and the like.

Yours Faithfully

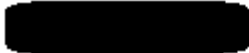

156

Naomi Stacey

From: [REDACTED]
Sent: 20 February 2018 06:42
To: Naomi Stacey
Subject: Re: Premises licence application - Bearz Bar, Island Street, Salcombe

Hi Naomi

Thanks for your email. My objections stand. And I would like to reiterate.. as follows,,, point of access onto a working busy narrow street, with cars new to the area, reversing passed entrance to bar to let other cars and working vehicles passed. And also, the fact it is an old, previously marine workshop, therefore the sound insulation is minimal.

Once again thank you for your reply

Kind regards

[REDACTED]

On 16 Feb 2018, at 10:39, Naomi Stacey <Naomi.Stacey@swdevon.gov.uk> wrote:

Dear Mr Westby

Thank you for your letter of representation in relation to the premises licence application for Bearz Bar, Island Street, Salcombe, TQ8 8DP.

Unless all representations are withdrawn we will be arranging a licensing sub-committee meeting (hearing) where the application will be determined. As you have made a relevant representation you will be notified of the details of the hearing once the consultation period has ended and will be invited to attend if you wish.

For your information I have attached a list of proposals on how the licensing objectives will be achieved which the applicant put forward on the application form, these will become conditions of the licence should it be granted. I have also attached a list of additional conditions and amendment to the hours, which the applicant has agreed with the Police. If there are any other changes to the application or additional conditions which you believe would address your concerns, please let me know. I am able to put these forward to the applicant and if we are able to reach an agreement we may be able to dispense with the need for a hearing.

The applicant has asked me to let you know that anyone with concerns about the application would be more than welcome to visit the premises to discuss these and see how the business is intending to operate. I have attached a copy of the proposed licence plan, showing the layout of the licensed premises and the separate children's soft play area.

At a hearing the licensing sub-committee will only be able to take into consideration reasons for objection that relate to the four licensing objectives:

- The prevention of crime and disorder
- Public safety
- The prevention of public nuisance
- The protection of children from harm

(16)

Naomi Stacey

From: [REDACTED]
Sent: 18 February 2018 18:28
To: SW-Licensing
Subject: Kidz and Co/Bearz Bar License

I'm writing in support of the application for an alcohol license for Bearz Bar in Salcombe. Due to the layout of the business and where the bar is situated I believe there should be little concern for noise and public nuisance, especially as the license will not be a late one. I also believe the layout will ensure children visiting the Kidz and Co will be safe from those in the bar-especially as these children will be with adults! I hope you support the application and the licence is granted.

Yours,

[REDACTED]

Naomi Stacey

From: [REDACTED]
Sent: 20 February 2018 22:43
To: SW-Licensing
Subject: Support of licensing - Bearz Bar Salcombe

20/03/2018

To whom it may concern,

I am writing this letter in support of the license of 'Bearz Bar' that is due to be opening the end of March 2018 on Island Street, Salcombe.

As someone who has grown up and lived in Salcombe the majority of my life, I have seen a number of businesses come and go. I am curious as to when a new business does come along how it merges into the town and appeals to both the local residents that live here all year around and the people that come to visit the town mostly in holiday seasons. 'Kidz and Co' is connected to the business 'Bearz Bar' the businesses are both owned by Corinne Lynn and are located within the same building based on Island street. 'Kidz and Co' has been such a strong part of bringing the community together here in Salcombe that I feel sadly has been lost over the years and I believe connected with 'Bearz Bar' both businesses combined can only make more of a positive impact on the community of Salcombe.

In regards to the license of 'Bearz Bar' I have discussed with Corinne Lynn, 'Bearz Bar' business owner, the objectives of the licensing and her plans that meet the requirements of these objectives. One of the objectives I believe are; prevention of crime. To my understanding 'Bearz Bar' plans to have a restaurant style approach where the staff will take orders and serve alcoholic beverages at the tables with their food orders. The general idea of the bar is to provide a relaxed atmosphere in a space where some light live music may be played occasionally and is somewhere nice to eat and drink on an evening which I believe is exactly what Salcombe needs. The bar stops serving drinks at 11pm which in regards to a drinking location is relatively early, the other bars and pubs in this area at least go onto midnight if not later, these venues are more likely to be the places to go to after having drinks and food earlier on at 'Bearz Bar'. My understanding of this bar concept personally doesn't evoke thoughts there will be crime and disorder as it simply isn't that style of bar. If any crime does take place, there are a number of 24 hour CCTV Cameras installed that will be able to track this type of behavior.

Another objective is the prevention of public nuisance- In relation to this; some residents that live nearby potentially might be concerned about the noise. The noise would only really occur either by the music that will be played or smokers that might desire to go outside the front of the building and converse in conversation near to where residents live. After speaking with business owner Corinne, I have been assured the plans for the bar is as follows - music is to be played until a certain time and any live music will be positioned right at the end of the building which is a great distance away from any housing. Anyone that appears to be a smoker that goes outside the front of the building will be immediately directed to the end of the street away from any nearby houses. I have also been assured by Corinne that the conditions of her license, agreed by the police is that nobody will be allowed to take their glasses outside to drink so the opportunity to congregate outside and create noise or disturbance will be at a minimum. Like any other licensed premises 'Bearz bar' will be running on a 'challenge 25' basis and anyone who appears under that age will be asked for relevant ID.

I sincerely wish Corinne the best of luck with her license application and business and look forward to seeing the final product of her renovations and improvements to the existing building.

18

Naomi Stacey

From: [REDACTED]
Sent: 20 February 2018 22:49
To: SW-Licensing
Subject: Bearz Bar, The Kidz and Co, Island Street, Salcombe, TQ8 8DP from The Kidz and Co.

To whom it may concern,

I write in support of the above application. The above will be a great addition to Salcombe for permanent residents, second home owners and also for seasonal holiday visitors. The below comments are written in the context of considering Salcombe to be my home from home as a second home owner and also as someone who has visited Salcombe on a regular basis since I was a young child.

The proposed offering by Bearz Bar will provide a much needed additional offering in Salcombe both in the daytime and more importantly in the evening and so this necessitates a change in the license for the premises. My understanding is that this concept will be a high end restaurant style, so people can come and eat in the evening, whilst enjoying a few drinks with their meal while seated at tables, as opposed to a bar concept where alcohol is consumed without food. As a result, it is not aimed at being a party / late night bar venue for teenagers / young adults and so when people leave the premises they will be making minimal noise and disturbance for local residents and so minimal issues are likely to arise in terms of any crime, public disorder or public nuisance issues. This is reinforced by the fact that the license applied for is to 11pm and not a late license.

In terms of music, my understanding is that this will routinely be background recorded music to help create the right ambience. As a result this will not create any significant noise or disturbance issues for local residents. When live music is played occasionally at the venue, this will be held at the back on the stage area, so as to minimise any possible noise or disturbance issues at the front of the building. As set out above, the whole concept is a restaurant style lounge bar, rather than any form of night club and so the occasional live music is unlikely to create any public safety issues.

It should also be noted that the proposed holder of the license is a responsible individual who has previous experience of running bars before and this concept has been carefully planned with appropriate consideration given to the local market and local residents to the venue. For example I am aware that there are already plans in place to ensure signs are placed on exits to remind people to be quiet when leaving the venue / asking them to respect the neighbours and plans to direct any smokers away from the building and residential areas, so both minimise and prevent any disturbance for local residents. To date the upstairs part of the venue has been used as a soft play area for young children with a cafe, this will remain unchanged going forward, with the exception that a separate entrance will be used for this part of the business and no alcohol will be served in the soft play cafe. As a result, the license being granted for downstairs will not create any safety issues for children attending the soft play.

In summary, I strongly feel that the above license should be granted as it will provide a great addition to this part of Salcombe in terms of a high end restaurant and lounge bar, will contribute to the local economy in the South Hams, for example creating additional local jobs and importantly will have a minimal impact on its local surroundings and local residents.

Yours faithfully,

[REDACTED]

(19)

Naomi Stacey

From: [REDACTED]
Sent: 18 February 2018 14:38
To: SW-Licensing
Subject: Bearz Bar, The Kidz & Co, Salcombe

To Whom It May Concern,

I write to you today with regards to the above Premises License application.

As a small company working in and around the South Hams region of Devon for many years, I have dealt with Ms Corinne Lynn in various forms over the years as well as other business within the Salcombe town area.

I have noticed the application made in connection with Kidz & Co and Bearz Bar, and having spoken to Ms Lynn, I am fully aware of the facts of what she is trying to achieve and I fully support it, as not only is it making full use of the space she has in the building, she is aiming to bring more to that part of the town, both in Live Music and local bands, and also other community groups, like evening Yoga & Fitness classes, among others.

I have seen the plans for the building as well as seen the work currently in progress in the building itself, and I'm really impressed with the thought and consideration of all aspects that have obviously gone into the planning for this.

Not only has Ms Lynn increased the CCTV presence around the proposed Licensed parts of the building, she has also gone to great expense both financially and in time to create a definite segregation between the proposed Bearz Bar and the existing Kidz & Co section.

You and I will both be aware of many licensed premises where there is a Children area that is easily accessible or in some cases even in the licensed area itself. Ms Lynn has been quite stubborn in her resolution to keep any licensed activity away from the Kidz & Co area. That along with the fact the play area is constantly minded by a Professional Childminder employed by Ms Lynn, shows her resolution to keep these two aspects of the business totally separate.

Not only has she gone to a great effort to keep things separate physically, she has also made great steps to ensure that while both areas of the business will be open to the general public during the day, the emphasis on the Bearz Bar area will be on the Café/Deli and tabled food and drink aspects, and she has emphasised that fact that no minors will be on the premises without adult supervision in the evening after 7pm.

With regards to the licensed area and the events within, from what I can see these events would be held at the rear of the building and not at the front, in order to keep any noise disruption to a minimum. I remind you of the Island Street Bar & Grill licensed premises just a couple of hundred yards down the road and, and the many Live Music events it holds very regularly throughout the year. I point you to the fact that Island St has an outside balcony and open windows where there is no protection against noise per se. Ms Lynn's proposed premises doesn't have this outside seating and balcony area, so offers that much more protection against noise pollution.

Finally, I have known Ms Lynn for several years now, and find her to be a truly responsible business person. I applaud the way she has built up Kidz & Co, and keep it going to the degree she has. She was battling against the current restraints South Hams & Devon County Council put upon us local businesses and she is building the business up well.

I have no qualms at all in supporting Ms Lynn's premises application and I welcome the application and look forward to visiting Bearz Bar when it opens.

Yours sincerely

20

Naomi Stacey

From: [REDACTED]
Sent: 19 February 2018 21:05
To: SW-Licensing
Subject: The Kidz and co / Bearz Bar license application

To whom it may concern. This email is sent in support of the application applied by The Kidz and co / Bearz Bar license application. I am very much in support of this application. Island Street is an area with very low traffic compared to Salcombe Fore Street, where, especially in the summer, members of the public (including families with young children) walk in the middle of the very well used road. Unlike Island Street, which has neither issue. This town, along with surrounding towns are very community orientated and as a result are generally low crime areas and I am confident this bar would not generate a sudden rise in crime. The bar is a completely separate entity to the existing play are, with the play area being upstairs and enclosed whilst the bar is going to be situated downstairs with the focus being on drink while you dine with added occasional acoustic music or jazz to accompany your experience. No one under the age of 18 years old will be allowed within the bar after 7pm, unless accompanied by an adult and no one will need to access the upstairs toilets as there are going to be restroom facilities (including disabled facilities) downstairs.

[REDACTED]

(21)

Naomi Stacey

From: [REDACTED]
Sent: 19 February 2018 12:04
To: SW-Licensing
Subject: Bearz Bar license

To whom it may concern,

I'm writing in approval of Bearz Bar license application. As a businesses owner myself [REDACTED] on Island Street I am fully confident that Corinne has taken all necessary procedures to satisfy the licence. We have been neighbours for over two years now and have never had any issues.

After hearing the initial plans I am pleased to see how the owner has considered the prevention of crime and disorder by the addition of cctv throughout the licensed areas.

I also think that the segregation between 'Bearz Bar' And Kidz and co is great as many bars and restaurants have the play area actually in the licensed area where as in this case they are separated and the Kidz and co is not licensed. I also know there is a crèche service where a professional childminder is employed to look after and care for the children.

I know people may be worried about the music aspect that the property will bring. However, again it is clear to me that the music they will be playing will be to accompany a restaurant style environment and not a loud 'drinking bar' environment which is very considerate of the residents that are nearby. I also understand that all live music will be kept to the rear of the building at the furthest point away from residential areas which is a great prevention of public nuisance and noise at the front of the premises.

Thanks

22

[REDACTED]

Knowle Road

Salcombe

Devon

TQ8 8EN

18th February 2018

Ref: Bearz Bar/The Kidz & Co Licensing Application

To Whom It May Concern,

I am writing in support of the above application. I believe concerns have been raised by several property owners who do not reside locally, therefore I would very much like to assuage any fears that may have arisen.

As a local resident of Salcombe, and indeed someone who works in existing licensed premises on Island Street, I warmly welcome both the expansion of a local business and indeed any enterprise which brings year-round employment into the town.

The main concerns against this license appear to be centred around an increase in noise in the area. At Island Street Bar and Grill, we are open until 12am at weekends, thus a full hour after the proposed opening hours at Bearz Bar. It is, in my view, self-evident that it would be extremely unlikely to affect late-night noise levels.

There also seems to be a great concern regarding Child safety, given that Bearz Bar will be run as a completely separate enterprise from the Kidz and Co soft play centre, with separate entrance it is highly implausible that young children would be allowed to wander "willy-nilly" into the licensed are of the site. It is also, preposterous to think that young children would somehow have easy access to alcoholic beverages given that the minimum age to purchase alcohol is 18 (16 with a main meal). It also worth noting that as a parent with a toddler I am a frequent customer of Kidz and Co, if I had any concerns as to my daughter's welfare I would have absolutely no hesitation in raising them both with the Licensing Committee and the Proprietor.

I hope this brief note is of use to yourselves, and that the License is granted, Heaven knows, the town of Salcombe in general and Island Street in particular are in desperate need of quality, year-round businesses and employment opportunities.

Yours Faithfully,

[REDACTED]
[REDACTED]
[REDACTED]

(23)

Naomi Stacey

From: [REDACTED]
Sent: 20 February 2018 23:16
To: SW-Licensing
Subject: Bearz Bar, The Kidz and Co, Island Street, Salcombe, TQ8 8DP from The Kidz and Co.

To whom it may concern,

I write in connection with the above licensing application which I fully support.

As I see it the new venue will be a great addition to Salcombe for everyone, whether they be home owners or those visiting Salcombe for their holidays.

Personally I have been visiting Salcombe for the past 12 years on a regular basis throughout the year and consider Salcombe to be my home from home having recently purchased a second home in Salcombe.

I believe the proposal by Bearz Bar will provide a much needed additional offering in Salcombe both in the daytime and more importantly in the evening and so this necessitates a change in the license for the premises.

It is my understanding that this concept will be for a high-end restaurant style, so people can come and eat in the evening, whilst enjoying a few drinks with their meal while seated at tables, as opposed to a bar concept where alcohol is consumed without food. As a result, it is not aimed at being a party / late night bar venue for teenagers / young adults and so when people leave the premises they will be making minimal noise and disturbance for local residents and so minimal issues are likely to arise in terms of any crime, public disorder or public nuisance issues. This is reinforced by the fact that the license applied for is to 11pm and not a late license.

In terms of music, my understanding is that this will routinely be background recorded music to help create the right ambience. As a result this will not create any significant noise or disturbance issues for local residents.

On the occasions when live music is played at the venue, this will be played at the back of the venue, so as to minimise any possible noise or disturbance issues at the front of the building. As set out above, the whole concept is a restaurant style lounge bar, rather than any form of night club and so the occasional live music is unlikely to create any public safety issues.

It should also be noted that the proposed holder of the license is a responsible individual who has previous experience of running bars before and this concept has been carefully planned with appropriate consideration given to the local market and local residents to the venue.

As an example I am aware that there are already plans in place to ensure signs are placed on exits to remind people to be quiet when leaving the venue / asking them to respect the neighbours and plans to direct any smokers away from the building and residential areas, so as to both minimise and prevent any disturbance for local residents.

To date the upstairs part of the venue has been used as a soft play area for young children with a cafe, this will remain unchanged going forward, with the exception that a separate entrance will be used for this part of the business and no alcohol will be served in the soft play cafe. As a result, the license being granted for downstairs will not create any safety issues for children attending the soft play.

I strongly feel that the above license should be granted as it will provide a great addition to this part of Salcombe and will contribute and enhance the local economy.

Yours faithfully

A large black rectangular redaction box covering the signature area.

24

Naomi Stacey

From: [REDACTED]
Sent: 20 February 2018 16:13
To: SW-Licensing
Subject: License Application for Bearz Bar at the Kidz and Co, Island St Salcombe

Dear to whom it may concern,

I believe that there has been a recent license application for Bearz Bar at the Kidz and Co on Island Street Salcombe which has received some objections and I would like this email to be considered as a letter of support on behalf of Corrine Lynn and Bearz Bar.

I would like to counteract the three objections which have been raised and below I will go into detail about each item.

- Public safety
- Prevention of public nuisance
- Protection of children from harm

Public safety – Bearz Bar is aware that their licensed alcohol license demands that they take responsibility for the sale and supply of alcohol. They are aware of the impact that alcohol has on the wider community, on crime and disorder and anti-social behaviours and would not take this responsibility lightly. They will trade as a restaurant eatery with alcohol not a bar designed for heavy drinking clients. Along with insuring that all those employed are aware, alert and able to use their initiative when serving alcohol to each and every one of their clients. Things such as overcrowding are not something that Bearz Bar foresees to be an issue, as the capacity of the building will never be stretched, ensuring that consequently other risks are avoided at all costs, such as fire issues or accidents on the premises. There will always be a trained first aider on site should there be an accident which will be dealt with on a case by case basis. Fire safety rules will be put in place across the building and all staff will be fully trained on the procedures so that in an event of a fire the issue is dealt with quickly and effectively whilst ensuring that the clients are escorted to the fire safety point in an orderly fashion with as little disruption for both themselves and the surrounding residents.

Prevention of public nuisance - Any live music which will be played, on an occasional basis, will be positioned at the rear of the property to ensure the noise disturbance is limited. Any smokers will be asked smoke away from any residential areas and alcohol service will end at 11pm as in adherence with the new updated license. Bearz Bar will be a restaurant style servery and not a establishment designed as a heavy drinking bar.

Protection of children from harm – Bearz Bar will operate as a normal bar, under normal bar rules with no service of alcohol to children and with ensure that no children well being will be put at risk. With the positioning of the bar downstairs, with direct access from the street there will also be private bathrooms for the clients of Bearz Bar. Therefore the Kidz

and Co is on a separate level and will have nothing to do with the bar. Alongside this the Kidz and co café upstairs is not a licensed premises and the opening hours are completely different to the proposed opening times of Bearz Bar.

I strongly believe that Bearz Bar will be an asset to Island street and Salcombe for residents and holiday makers alike as a civilised establishment to spend time in.

Thank you for your time,

Yours Sincerely

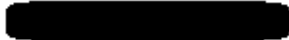

25

Naomi Stacey

From: [REDACTED]
Sent: 20 February 2018 23:30
To: SW-Licensing
Subject: Bearz Bar, The Kidz and Co, Island Street, Salcombe, TQ8 8DP from The Kidz and Co.

Dear Sir or Madam,

We write to support the above application. We consider that this will provide a valuable addition to this area of Salcombe and offer an good alternative to current offerings during the daytime and evening. It is located away from the main residential areas of Salcombe and so will have a minimal impact of local residents either permanent, second home owners or seasonal ones. The license request is to 11pm rather than a late license and again reinforces the fact that there will be minimal impact on local residents.

The concept of Bearz Bar is a high end restaurant style with a bar and lounge area. This will attract those looking to enjoy a meal out and the license will enable them to enjoy an alcoholic drink with their food. Given this set up, it is unlikely to attract a younger crowd looking for more of a bar / late night venue environment / drinking environment. By attracting this type of clientele and the license going to 11pm only means that there should be minimal issues arising in terms of noise and disturbance in close vicinity to the premises. As a direct result, there should also be very limited impact on other possible areas of concern, such as possible increased crime, public disorder or public nuisance.

There will be a clear distinction between Bearz Bar and Kidz and Co soft play and so the granting of a licence to the bar should not raise any concerns regarding the safety of children attending the soft play facility upstairs. We are aware that a separate entrance is being used going forward for the soft play and that no alcohol will be served in the soft play cafe upstairs. In addition the toilet facilities are being relocated to the ground floor which means that people using the bar will not have to enter the soft play to use these facilities going forward.

As for music, background recorded music will be played normally in the bar. This will not create any significant noise or disturbance issues for local residents. When live music is played occasionally at the bar, this will be set up at the rear of the venue, so as to minimise any impact of local residents. It is unlikely that any live music events at the bar will cause public safety concerns due to the restaurant style set up and clientele being sought.

We consider that the above license application should be supported and offer this view with no direct interest in either of the businesses mentioned above. It will provide a valuable addition to Island Street and Salcombe in general throughout the year.

[REDACTED]

26

Naomi Stacey

From: [REDACTED]
Sent: 18 February 2018 14:15
To: SW-Licensing
Subject: Re:- License application for The Bearz Bar, The Kids & Co, Salcombe.

To whom it may concern.

I support the alcohol license for the new bar at The Bearz Bar within the premises of The Kidz and Co. The Bearz Bar is predominantly a Restaurant offering occasional music nights. Salcombe is in desperate need of something different within the town.

Alcohol is not sold in the area where the children play, the bar is located at the back of the premises overlooking Batson Creek, noise levels would be at a minimum.

Yours sincerely

[REDACTED]

This page is intentionally left blank

Bearz Bar, Island Street, Salcombe – location maps

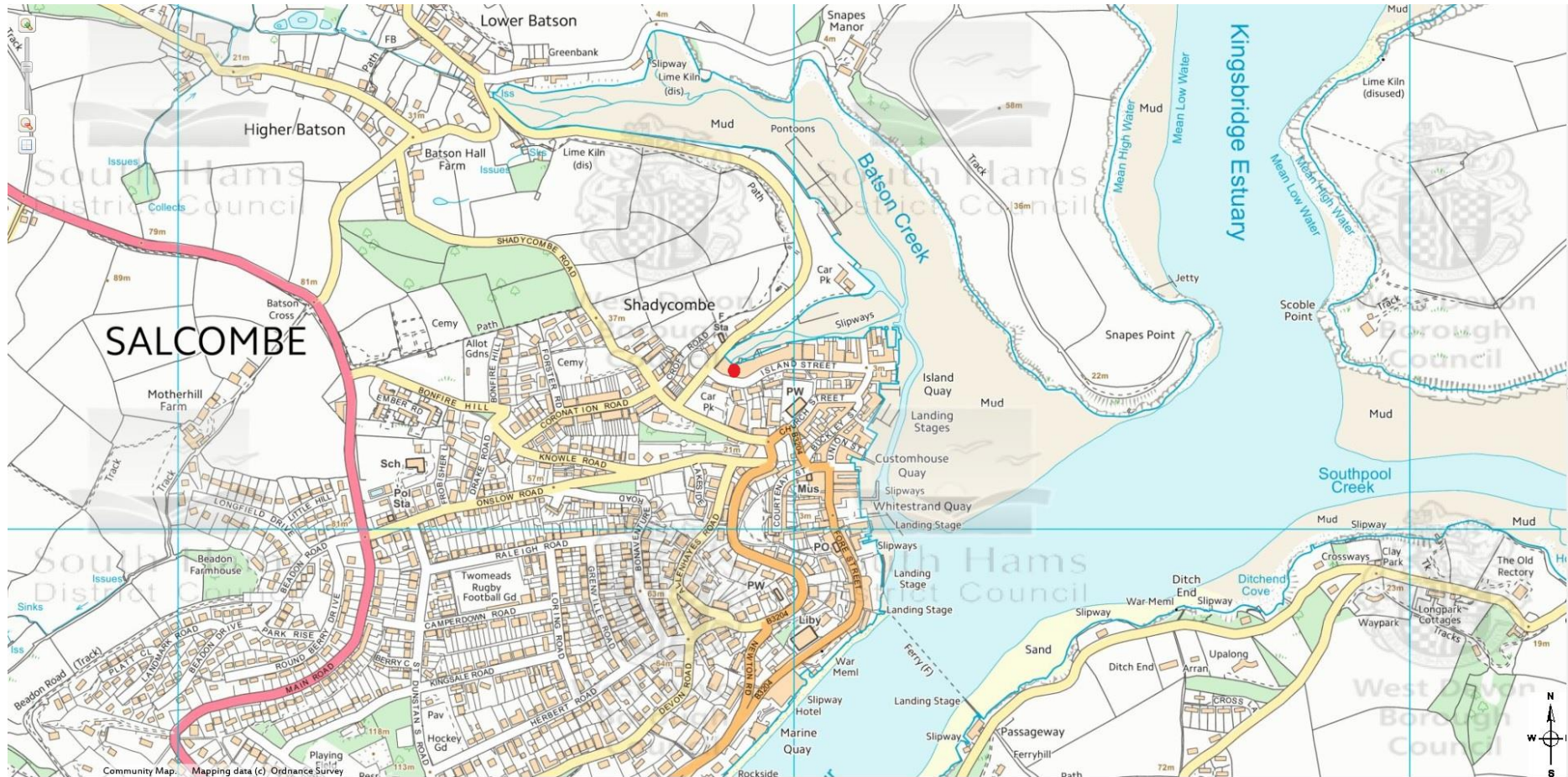

● Bearz Bar

Bearz Bar, Island Street, Salcombe – location maps

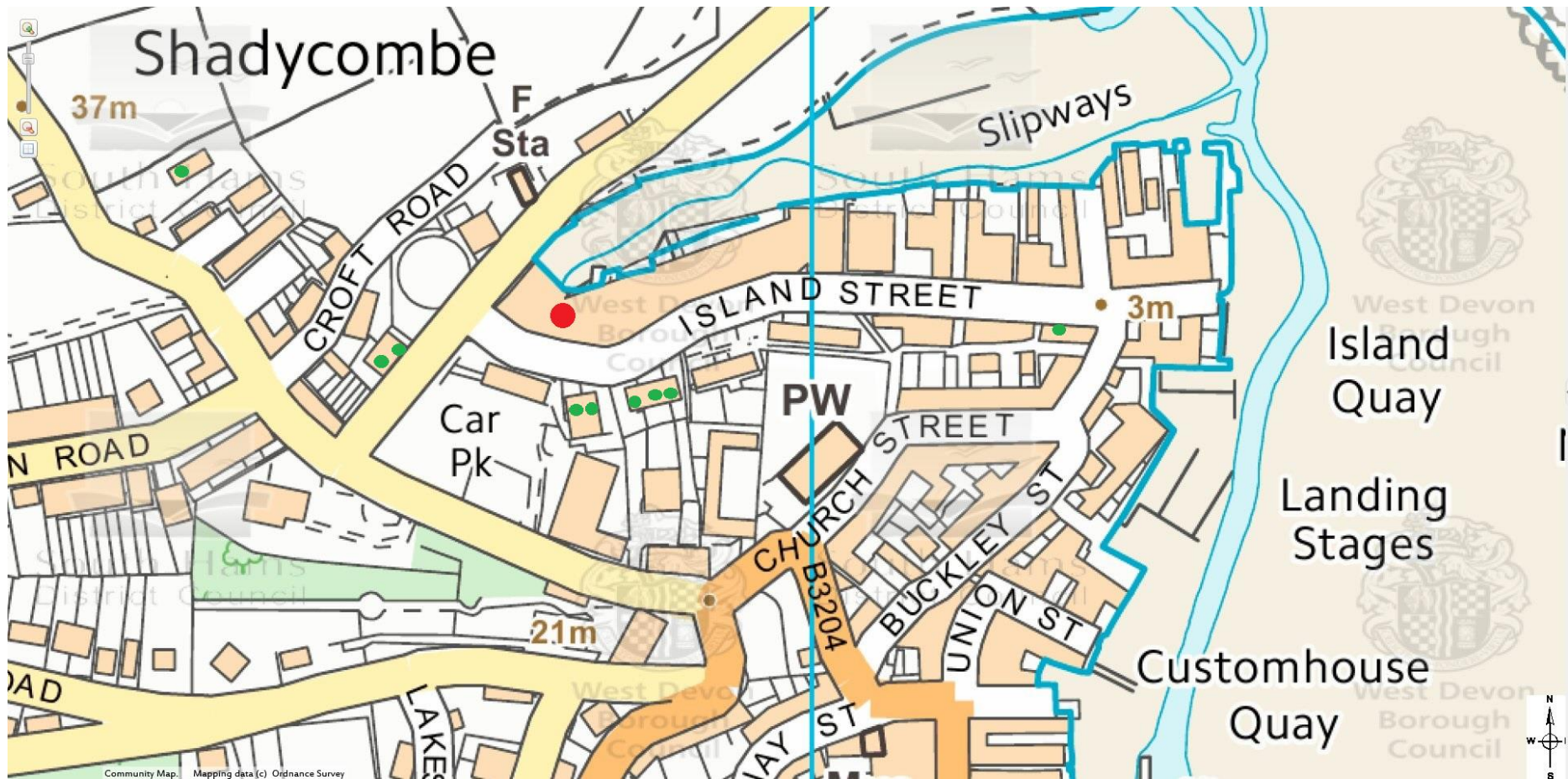

- Bearz Bar
- Nearby locations of objectors

Bearz Bar, Island Street, Salcombe – location maps



© Crown copyright & database rights 2016 Ordnance Survey data, West Devon B.C. 100023302 and South Hams D.C. 100022628.

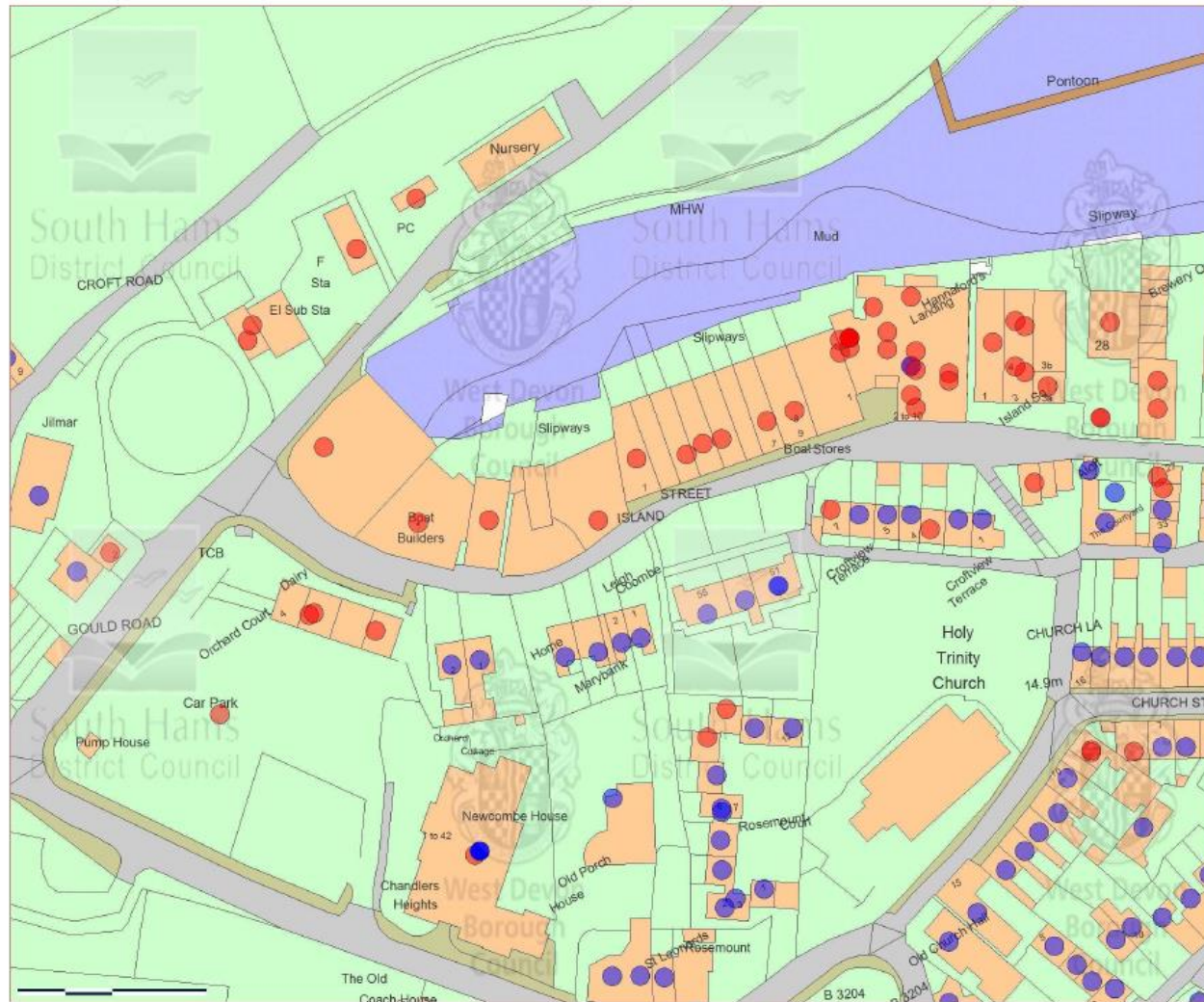

Printed at A4: 1:1250

Workspace: GIS Data

Printed by

Date 8th March 2018

Status

Min X: 273694.59

Min Y: 39074.71

Max X: 274148.37

Max Y: 39433.22



Business premises



Residential properties

This page is intentionally left blank

Bearz Bar, Island Street, Salcombe – photos of area



Bearz Bar, Island Street, Salcombe – photos of area



Opposite the premises



Bearz Bar, Island Street, Salcombe – photos of area



Junction with Gould Road



Bearz Bar, Island Street, Salcombe – photos of area



Junction with Gould Road



Bearz Bar, Island Street, Salcombe – photos of area



Rear of premises



This page is intentionally left blank